

PERFORMANCE DATA

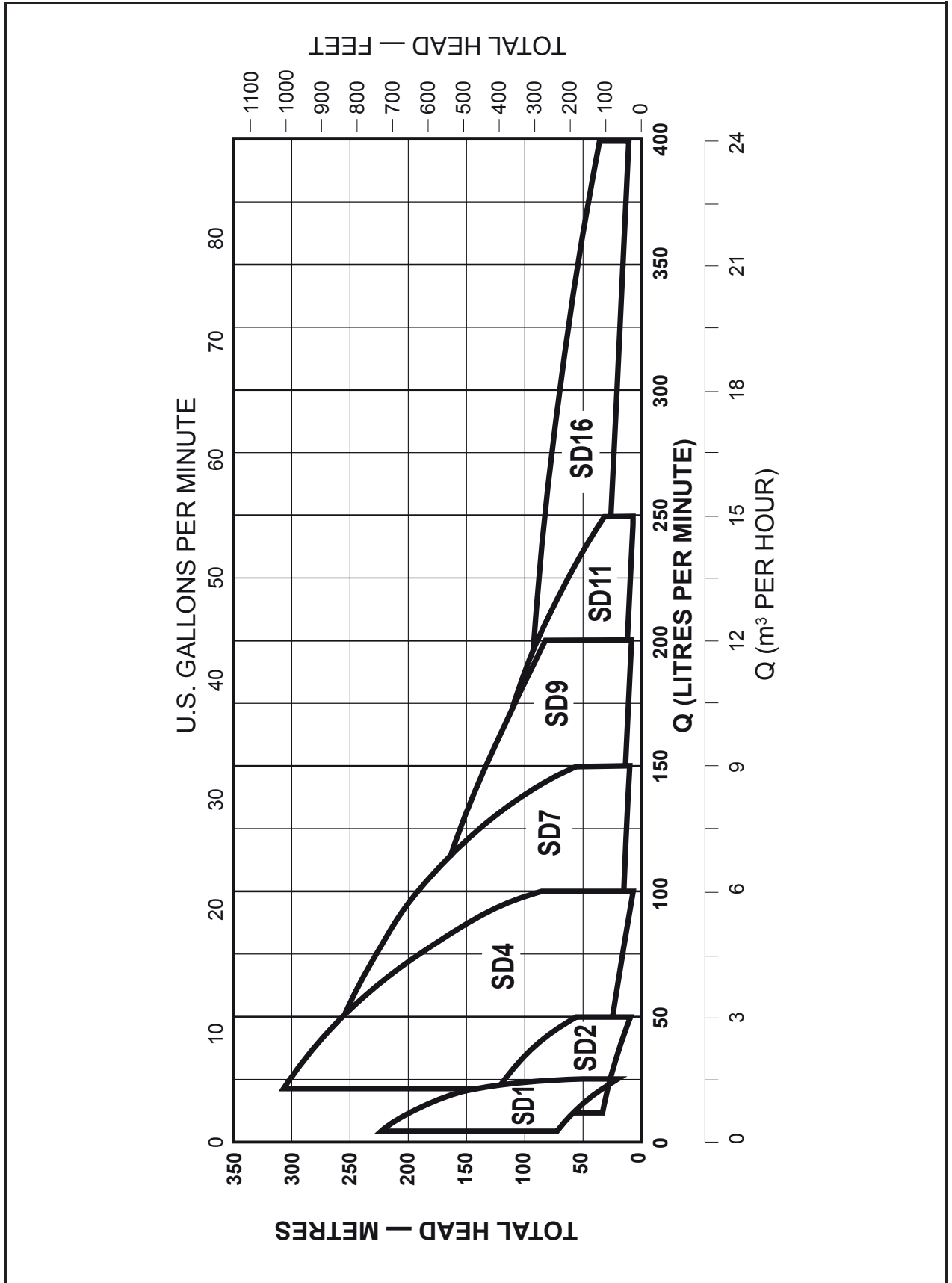

A division of Pentair Flow Control Pacific Pty Ltd A.B.N. 83 000 922 690

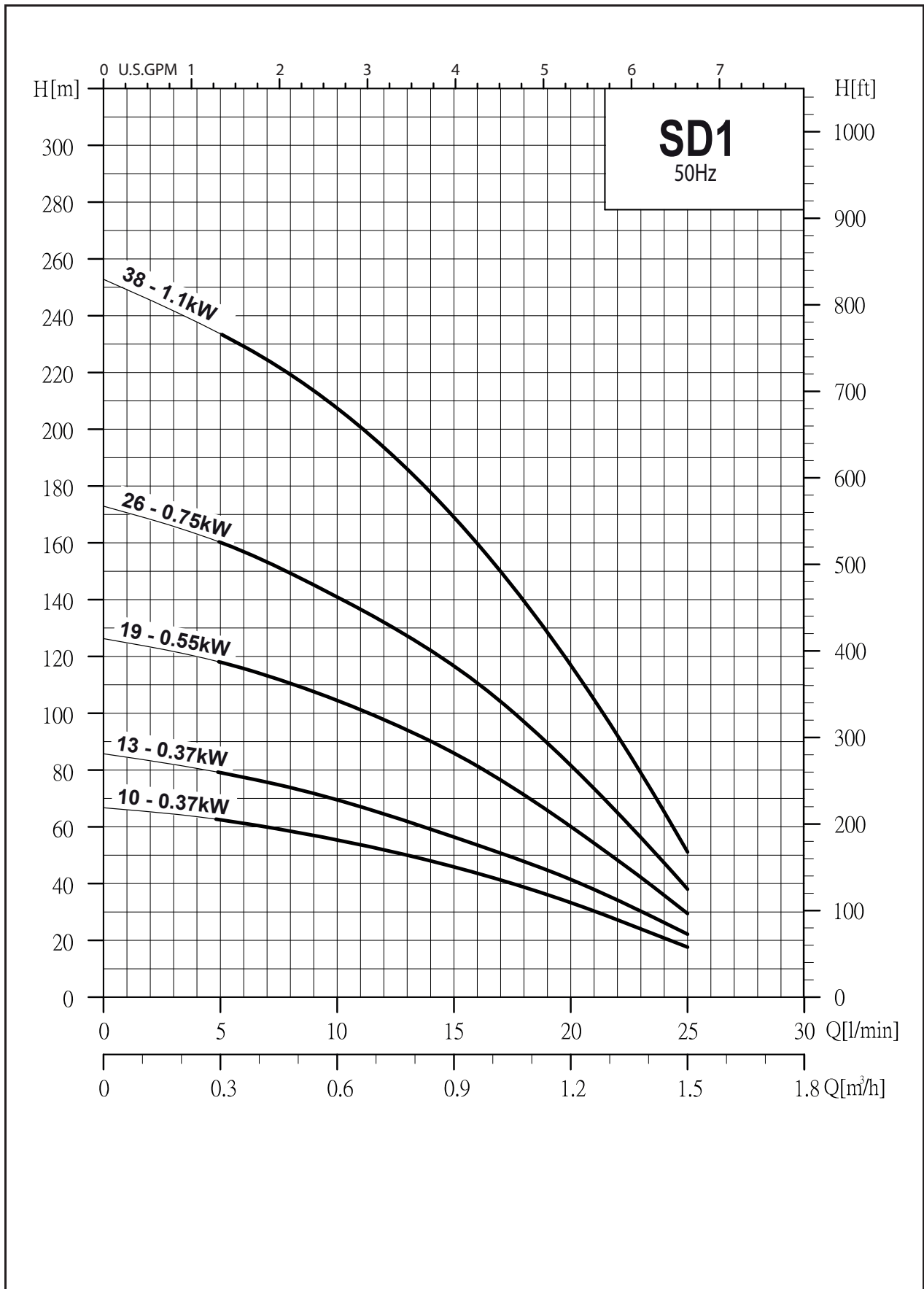

MODEL
SD1

“SD” Series
4 inch (100mm)
Submersible Borehole Pumps



TECHNICAL DATA

SD1 DIMENSIONS & WEIGHTS

MODEL	NO. OF STAGES	MOTOR		DIMENSIONS (mm)				MASS (kg)	
		kW	DIAM	A	B	C	D	PUMP	MOTOR
With Single Phase SAVA Motors									
SD1-10	10	0.37	4"	670	346	324	32mm (1 1/4") BSPF Pump Outlet	3.3	7.3
SD1-13	13	0.37	4"	723	346	377		3.7	7.3
SD1-19	19	0.55	4"	846	365	481		4.7	8.2
SD1-26	26	0.75	4"	1022	380	642		5.8	8.8
SD1-38	38	1.1	4"	1269	405	864		8.2	10.0
With Three Phase SAVA Motors									
SD1-10	10	0.37	4"	654	330	324	32mm (1 1/4") BSPF Pump Outlet	3.3	6.7
SD1-13	13	0.37	4"	707	330	377		3.7	6.7
SD1-19	19	0.55	4"	827	346	481		4.7	7.4
SD1-26	26	0.75	4"	1007	365	642		5.8	8.2
SD1-38	38	1.1	4"	1244	380	864		8.2	8.9

ELECTRICAL DATA 4 INCH MOTORS 240V 50Hz SINGLE PHASE & 415V 50Hz 3 PHASE

MOTOR kW	THRUST kg	FULL LOAD AMPS	NOMINAL RPM	LOCK ROTOR AMPS
4 INCH SAVA SINGLE PHASE MOTORS				
0.37	204	3.7	2840	12
0.55	204	4.3	2840	15
0.75	204	5.7	2840	20
1.1	204	7.8	2840	32
4 INCH SAVA 3 PHASE MOTORS				
0.37	204	1.2	2820	4.5
0.55	204	1.6	2830	6.7
0.75	204	2.1	2830	8.9
1.1	204	2.7	2840	12

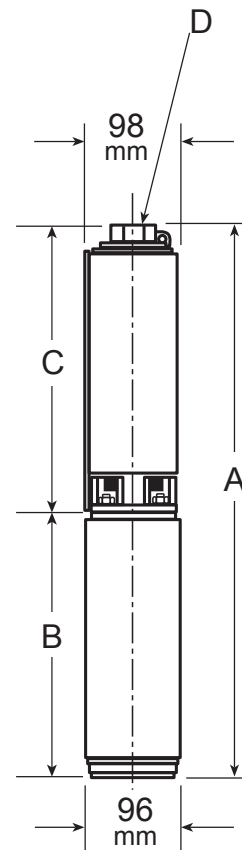

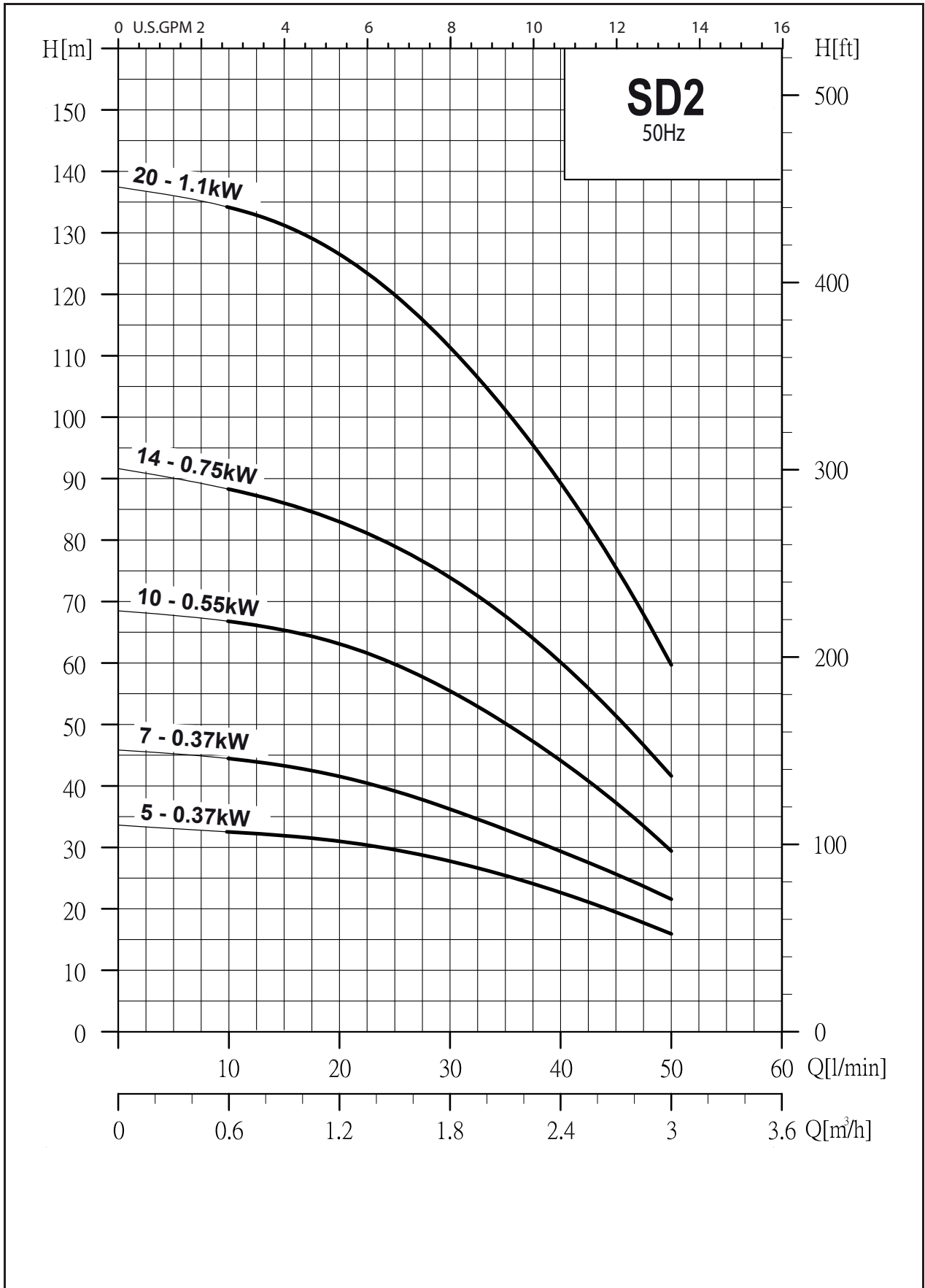

A division of Pentair Flow Control Pacific Pty Ltd A.B.N. 83 000 922 690

MODEL
SD2

“SD” Series
4 inch (100mm)
Submersible Borehole Pumps



TECHNICAL DATA

SD2 DIMENSIONS & WEIGHTS

MODEL	NO. OF STAGES	MOTOR		DIMENSIONS (mm)				MASS (kg)	
		KW	DIAM	A	B	C	D	PUMP	MOTOR
With Single Phase SAVA Motors									
SD2-05	5	0.37	4"	582	346	236	32mm (1 1/4") BSPF Pump Outlet	2.5	7.3
SD2-07	7	0.37	4"	617	346	271		2.8	7.3
SD2-10	10	0.55	4"	689	365	324		3.3	8.2
SD2-14	14	0.75	4"	774	380	394		3.9	8.8
SD2-20	20	1.1	4"	904	405	499		4.9	10.0
With Three Phase SAVA Motors									
SD2-05	5	0.37	4"	566	330	236	32mm (1 1/4") BSPF Pump Outlet	2.5	6.7
SD2-07	7	0.37	4"	601	330	271		2.8	6.7
SD2-10	10	0.55	4"	670	346	324		3.3	7.4
SD2-14	14	0.75	4"	759	365	394		3.9	8.2
SD2-20	20	1.1	4"	879	380	499		4.9	8.9

ELECTRICAL DATA 4 INCH MOTORS 240V 50Hz SINGLE PHASE & 415V 50Hz 3 PHASE

MOTOR kW	THRUST kg	FULL LOAD AMPS	NOMINAL RPM	LOCK ROTOR AMPS
4 INCH SAVA SINGLE PHASE MOTORS				
0.37	204	3.7	2840	12
0.55	204	4.3	2840	15
0.75	204	5.7	2840	20
1.1	204	7.8	2840	32
4 INCH SAVA 3 PHASE MOTORS				
0.37	204	1.2	2820	4.5
0.55	204	1.6	2830	6.7
0.75	204	2.1	2830	8.9
1.1	204	2.7	2840	12

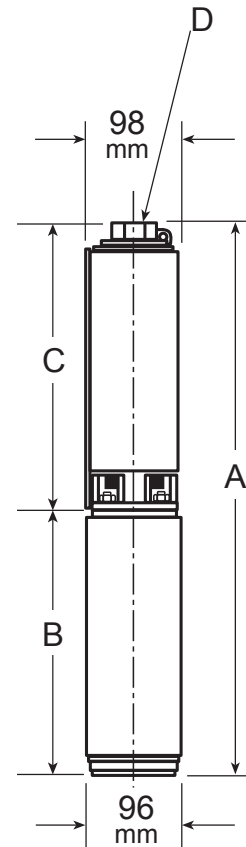

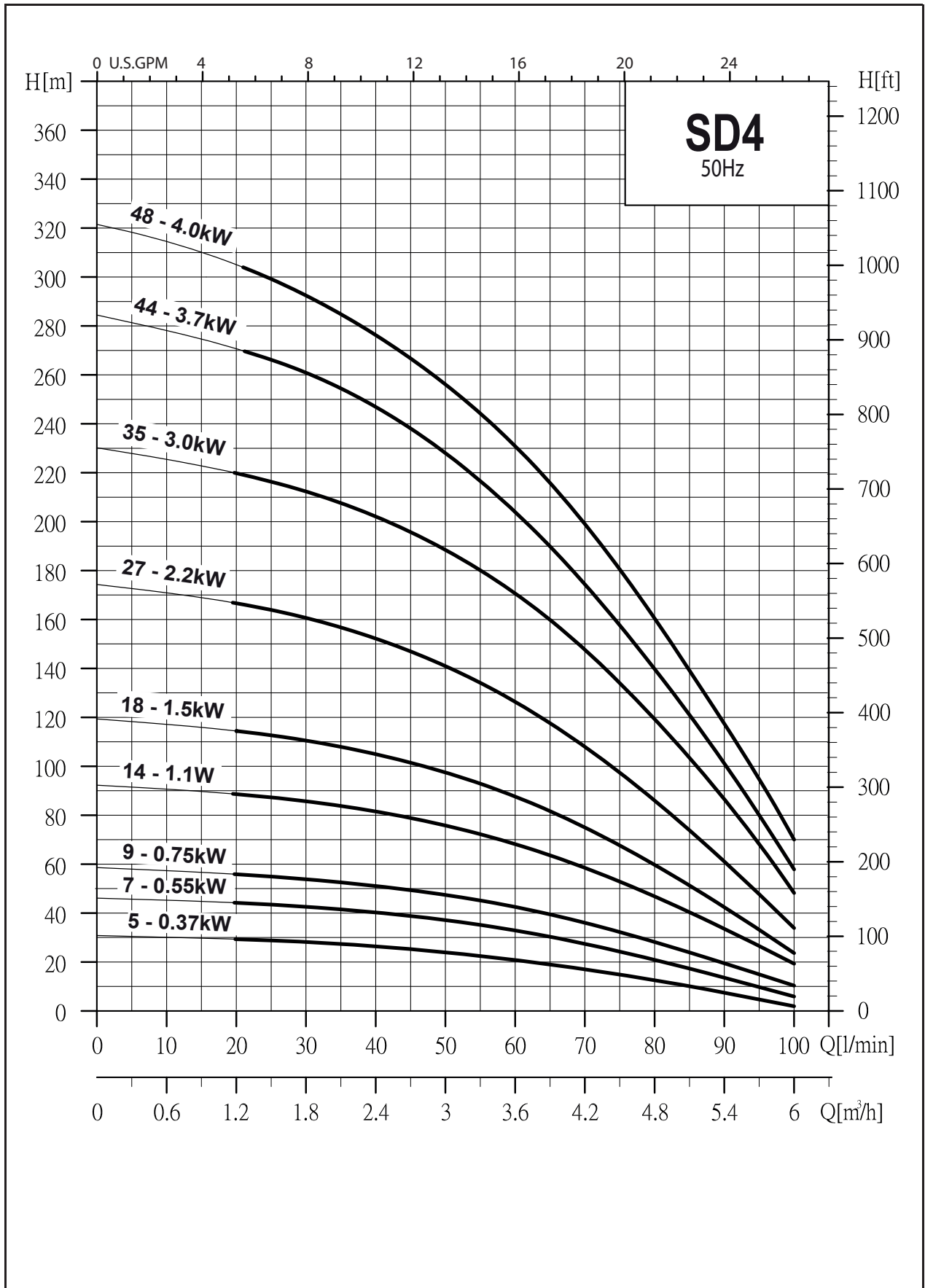

A division of Pentair Flow Control Pacific Pty Ltd A.B.N. 83 000 922 690

MODEL
SD4

“SD” Series
4 inch (100mm)
Submersible Borehole Pumps



TECHNICAL DATA

SD4 DIMENSIONS & WEIGHTS

MODEL	NO. OF STAGES	MOTOR		DIMENSIONS (mm)				MASS (kg)	
		kW	DIAM	A	B	C	D	PUMP	MOTOR
With Single Phase SAVA Motors									
SD4-05	5	0.37	4"	603	346	257	32mm (1 1/4") BSPF Pump Outlet	2.7	7.3
SD4-07	7	0.55	4"	666	365	301		3.0	8.2
SD4-09	9	0.75	4"	724	380	344		3.3	8.8
SD4-14	14	1.1	4"	857	405	452		4.1	10.0
SD4-18	18	1.5	4"	978	440	538		4.7	11.5
SD4-27	27	2.2	4"	1262	495	767		6.2	14.0
With Three Phase SAVA Motors									
SD4-05	5	0.37	4"	587	330	257	32mm (1 1/4") BSPF Pump Outlet	2.7	6.7
SD4-07	7	0.55	4"	647	346	301		3.0	7.4
SD4-09	9	0.75	4"	709	365	344		3.3	8.2
SD4-14	14	1.1	4"	832	380	452		4.1	8.9
SD4-18	18	1.5	4"	943	405	538		4.7	10.0
SD4-27	27	2.2	4"	1207	440	767		6.2	11.6
SD4-35	35	4	4"	1541	607	934		7.9	15.2
SD4-44	44	4	4"	1735	607	1128		9.3	19.5

ELECTRICAL DATA 4 INCH MOTORS 240V 50Hz SINGLE PHASE & 415V 50Hz 3 PHASE

MOTOR kW	THRUST kg	FULL LOAD AMPS	NOMINAL RPM	LOCK ROTOR AMPS
4 INCH SAVA SINGLE PHASE MOTORS				
0.37	204	3.7	2840	12
0.55	204	4.3	2840	15
0.75	204	5.7	2840	20
1.1	204	7.8	2840	32
1.5	204	9.8	2850	38
2.2	306	15	2820	46
4 INCH SAVA 3 PHASE MOTORS				
0.37	204	1.2	2820	4.5
0.55	204	1.6	2830	6.7
0.75	204	2.1	2830	8.9
1.1	204	2.7	2840	12
1.5	204	3.6	2840	14
2.2	306	5.4	2840	22
4	510	9.9	2855	49

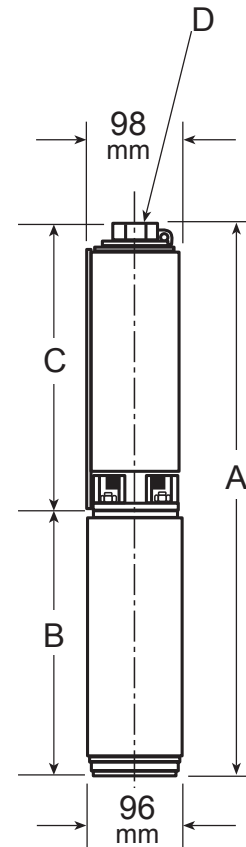

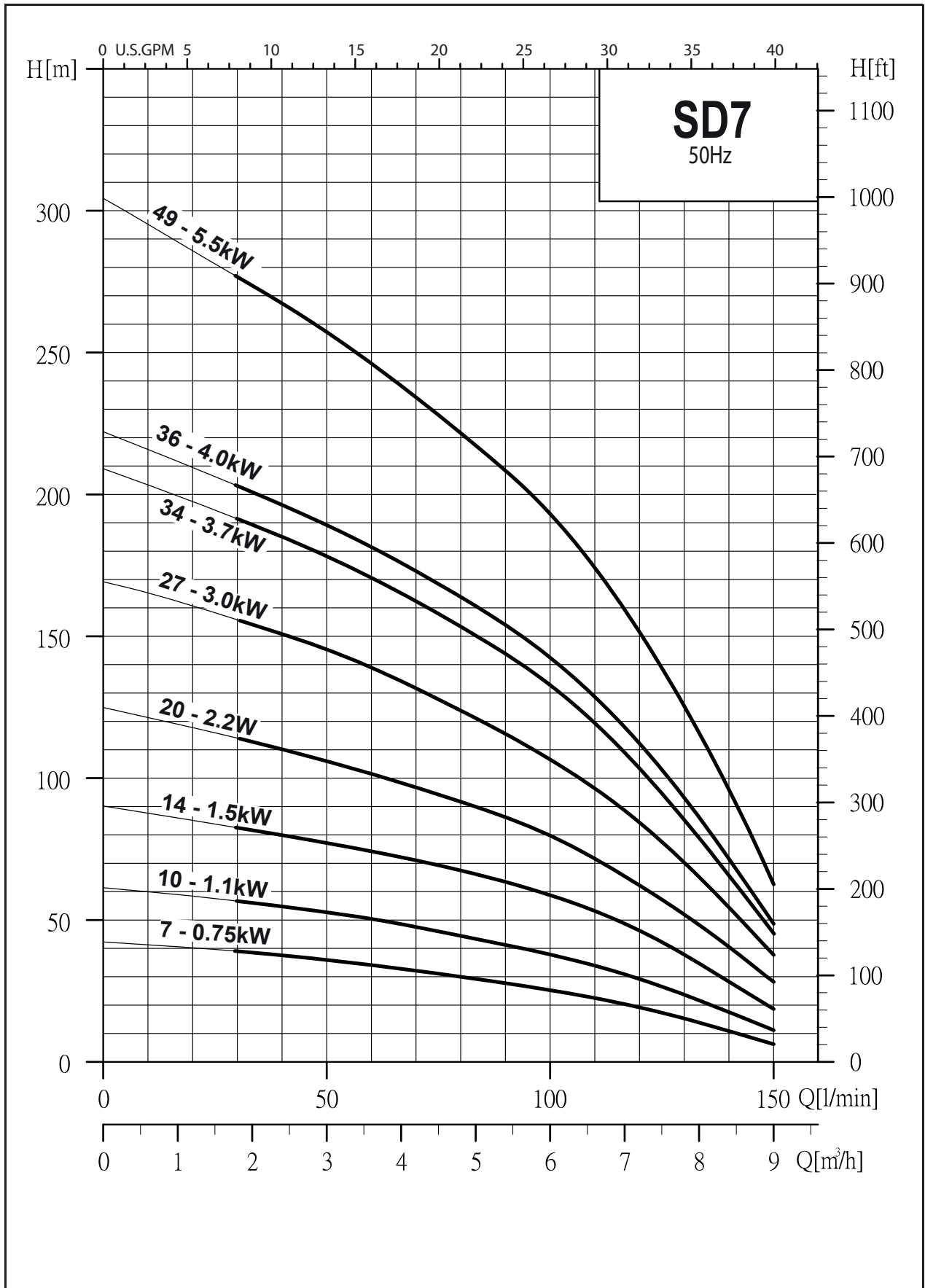

MODEL
SD7

“SD” Series
4 inch (100mm)
Submersible Borehole Pumps



TECHNICAL DATA

SD7 DIMENSIONS & WEIGHTS

MODEL	NO. OF STAGES	MOTOR		DIMENSIONS (mm)				MASS (kg)	
		kW	DIAM	A	B	C	D	PUMP	MOTOR
With Single Phase SAVA Motors									
SD7-07	7	0.75	4"	770	380	390	50mm (2") BSPF Pump Outlet	3.7	8.8
SD7-10	10	1.1	4"	888	405	483		4.6	10.0
SD7-14	14	1.5	4"	1047	440	607		5.7	11.5
SD7-20	20	2.2	4"	1226	395	831		7.5	14.0
With Three Phase SAVA Motors									
SD7-07	7	0.75	4"	755	365	390	50mm (2") BSPF Pump Outlet	3.7	8.2
SD7-10	10	1.1	4"	863	380	483		4.6	8.9
SD7-14	14	1.5	4"	1012	405	607		5.7	10.0
SD7-20	20	2.2	4"	1271	440	831		7.5	11.6
SD7-27	27	4	4"	1655	607	1048		9.6	19.5
SD7-34	34	4	4"	1864	607	1257		11.6	19.5

ELECTRICAL DATA 4 INCH MOTORS 240V 50Hz SINGLE PHASE & 415V 50Hz 3 PHASE

MOTOR kW	THRUST kg	FULL LOAD AMPS	NOMINAL RPM	LOCK ROTOR AMPS
4 INCH SAVA SINGLE PHASE MOTORS				
0.75	204	5.7	2840	20
1.1	204	7.8	2840	32
1.5	204	9.8	2850	38
2.2	306	15	2820	46
4 INCH SAVA 3 PHASE MOTORS				
0.75	204	2.1	2830	8.9
1.1	204	2.7	2840	12
1.5	204	3.6	2840	14
2.2	306	5.4	2840	22
4	510	9.9	2855	49

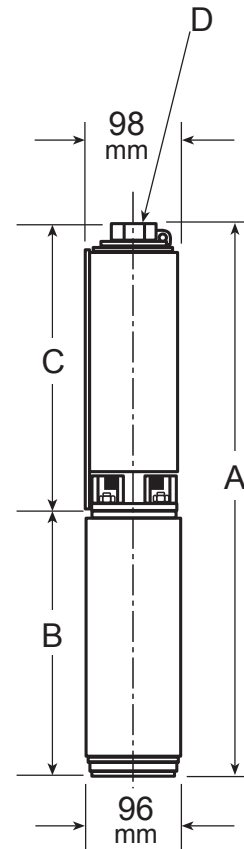

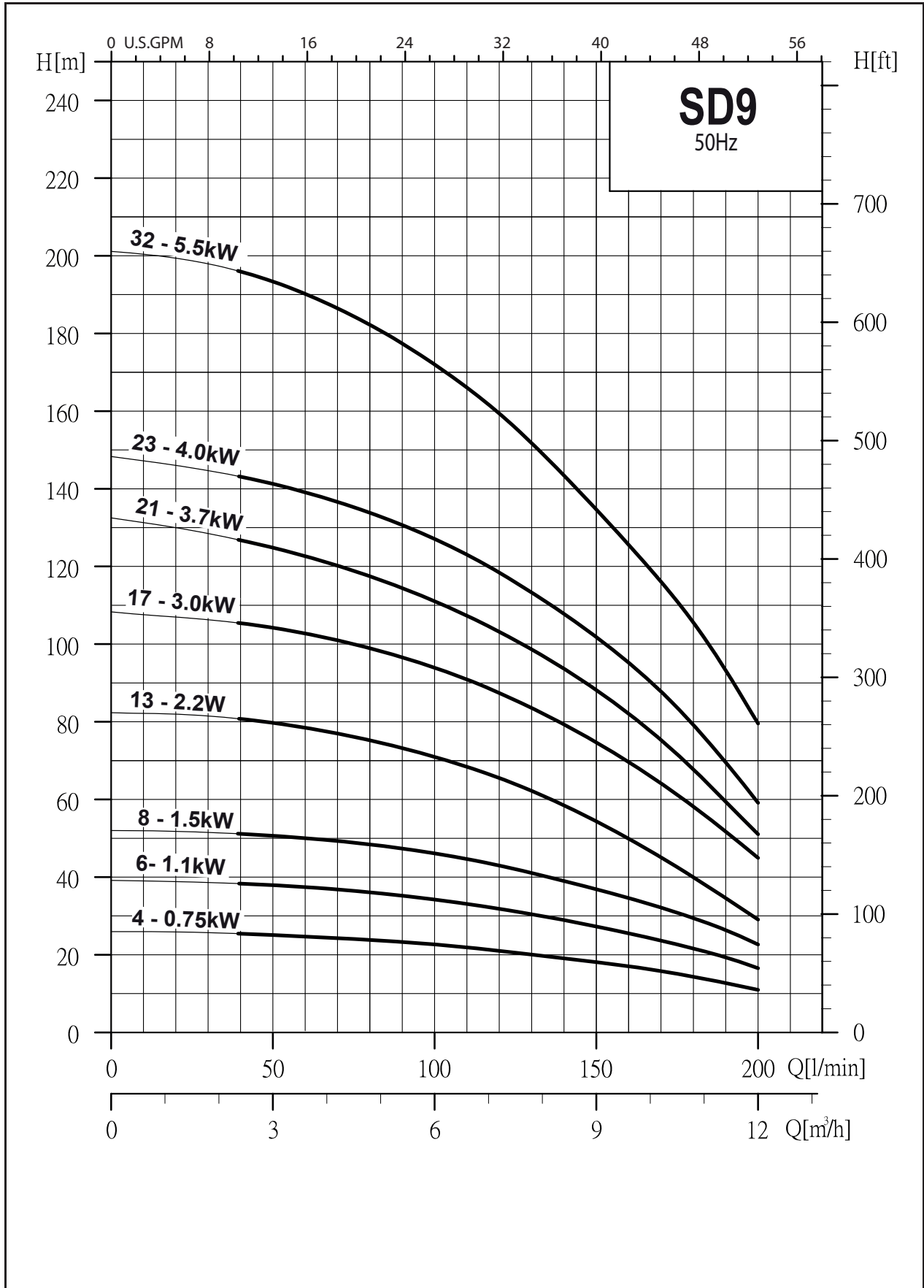

MODEL
SD9

“SD” Series
4 inch (100mm)
Submersible Borehole Pumps



TECHNICAL DATA

SD9 DIMENSIONS & WEIGHTS

MODEL	NO. OF STAGES	MOTOR		DIMENSIONS (mm)				MASS (kg)	
		kW	DIAM	A	B	C	D	PUMP	MOTOR
With Single Phase SAVA Motors									
SD9-04	4	0.75	4"	674	380	294	50mm (2") BSPF Pump Outlet	2.8	8.8
SD9-06	6	1.1	4"	761	405	356		3.4	10.0
SD9-08	8	1.5	4"	858	440	418		4.0	11.5
SD9-13	13	2.2	4"	1068	495	573		5.5	14.0
With Three Phase SAVA Motors									
SD9-04	4	0.75	4"	659	365	294	50mm (2") BSPF Pump Outlet	2.8	8.2
SD9-06	6	1.1	4"	736	380	356		3.4	8.9
SD9-08	8	1.5	4"	823	405	418		4.0	10.0
SD9-13	13	2.2	4"	1013	440	573		5.5	11.6
SD9-17	17	3.0	4"	1213	516	697		6.6	15.2
SD9-21	21	4.0	4"	1466	607	859		7.8	19.5
SD9-23	23	4.0	4"	1528	607	921		8.4	19.5
SD9-32	32	5.5	4"	1921	683	1238		11.0	23.1

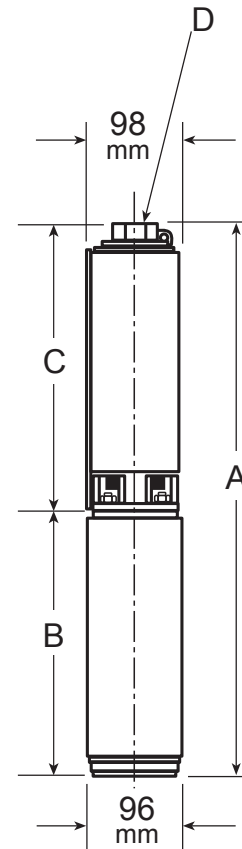

ELECTRICAL DATA 4 INCH MOTORS 240V 50Hz SINGLE PHASE & 415V 50Hz 3 PHASE

MOTOR kW	THRUST kg	FULL LOAD AMPS	NOMINAL RPM	LOCK ROTOR AMPS
4 INCH SAVA SINGLE PHASE MOTORS				
0.75	204	5.7	2840	20
1.1	204	7.8	2840	32
1.5	204	9.8	2850	38
2.2	306	15	2820	46
4 INCH SAVA 3 PHASE MOTORS				
0.75	204	2.1	2830	8.9
1.1	204	2.7	2840	12
1.5	204	3.6	2840	14
2.2	306	5.4	2840	22
3	510	7.5	2850	43
4	510	9.9	2855	49
5.5	510	13.8	2850	65

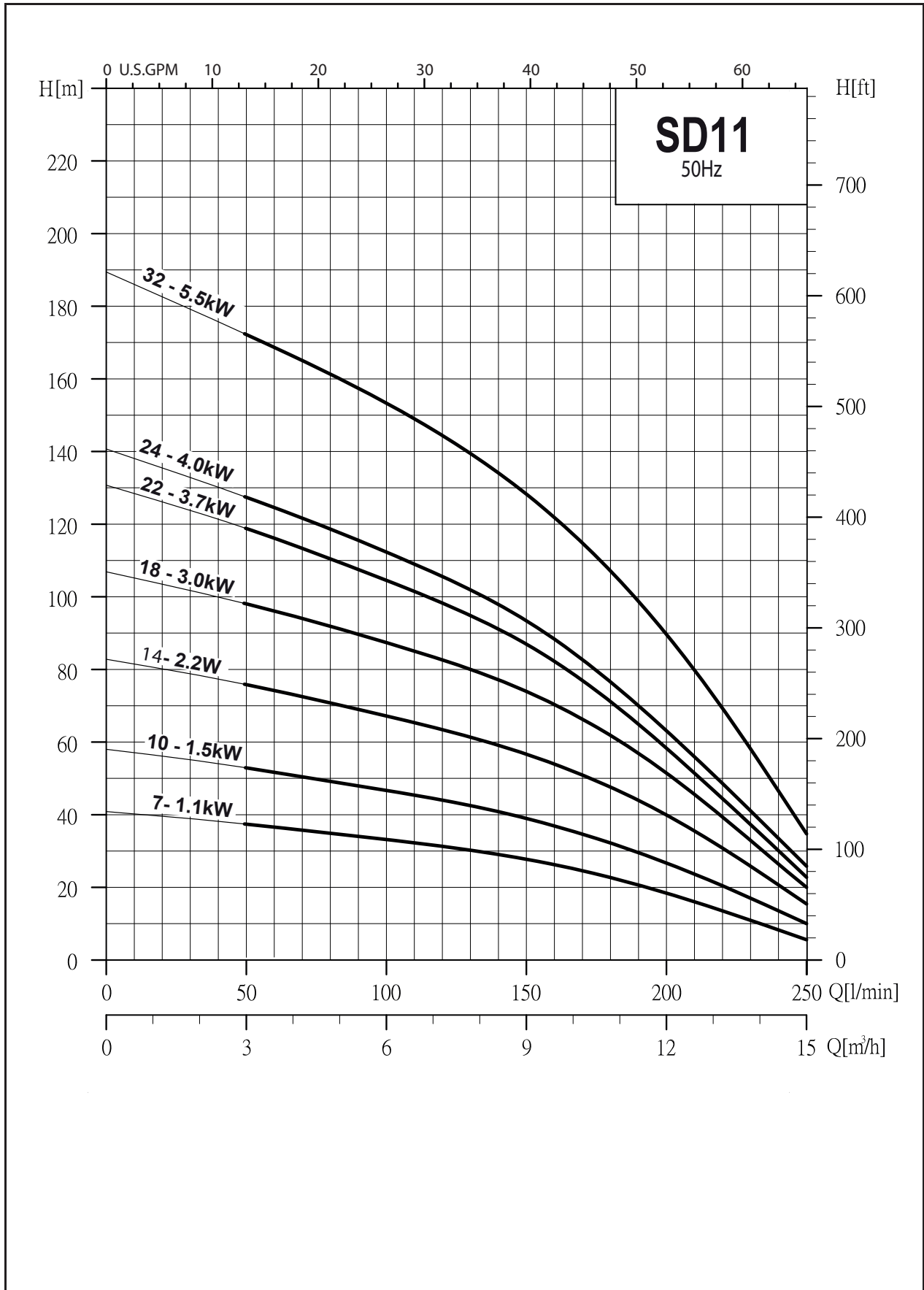

A division of Pentair Flow Control Pacific Pty Ltd A.B.N. 83 000 922 690

MODEL
SD11

“SD” Series
4 inch (100mm)
Submersible Borehole Pumps



TECHNICAL DATA

SD11 DIMENSIONS & WEIGHTS

MODEL	NO. OF STAGES	MOTOR		DIMENSIONS (mm)				MASS (kg)	
		kW	DIAM	A	B	C	D	PUMP	MOTOR
With Single Phase SAVA Motors									
SD11-07	7	1.1	4"	942	405	537	50mm (2") BSPF Pump Outlet	5.3	10.0
SD11-10	10	1.5	4"	1133	440	693		6.7	11.5
SD11-14	14	2.2	4"	1396	495	901		8.5	14.0
With Three Phase SAVA Motors									
SD11-07	7	1.1	4"	917	380	537	50mm (2") BSPF Pump Outlet	5.3	8.9
SD11-10	10	1.5	4"	1098	405	693		6.7	10.0
SD11-14	14	2.2	4"	1341	440	901		8.5	11.6
SD11-18	18	3	4"	1663	516	1147		10.4	15.2
SD11-22	22	4.0	4"	1952	607	1345		12.3	19.5
SD11-24	24	4.0	4"	2056	607	1449		13.2	19.5
SD11-32	32	5.5	4"	2549	683	1866		17.0	23.1

ELECTRICAL DATA 4 INCH MOTORS 240V 50Hz SINGLE PHASE & 415V 50Hz 3 PHASE

MOTOR kW	THRUST kg	FULL LOAD AMPS	NOMINAL RPM	LOCK ROTOR AMPS
4 INCH SAVA SINGLE PHASE MOTORS				
1.1	204	7.8	2840	32
1.5	204	9.8	2850	38
2.2	306	15	2820	46
4 INCH SAVA 3 PHASE MOTORS				
1.1	204	2.7	2840	12
1.5	204	3.6	2840	14
2.2	306	5.4	2840	22
3	510	7.5	2850	43
4	510	9.9	2855	49
5.5	510	13.8	2850	65

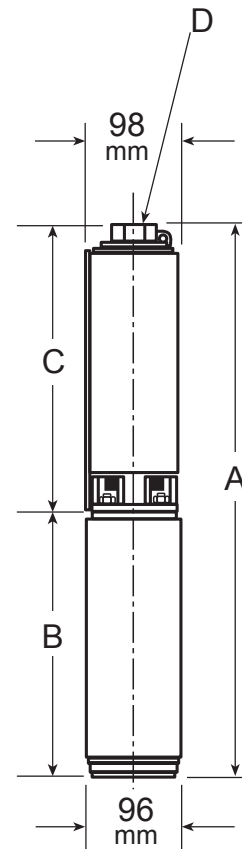

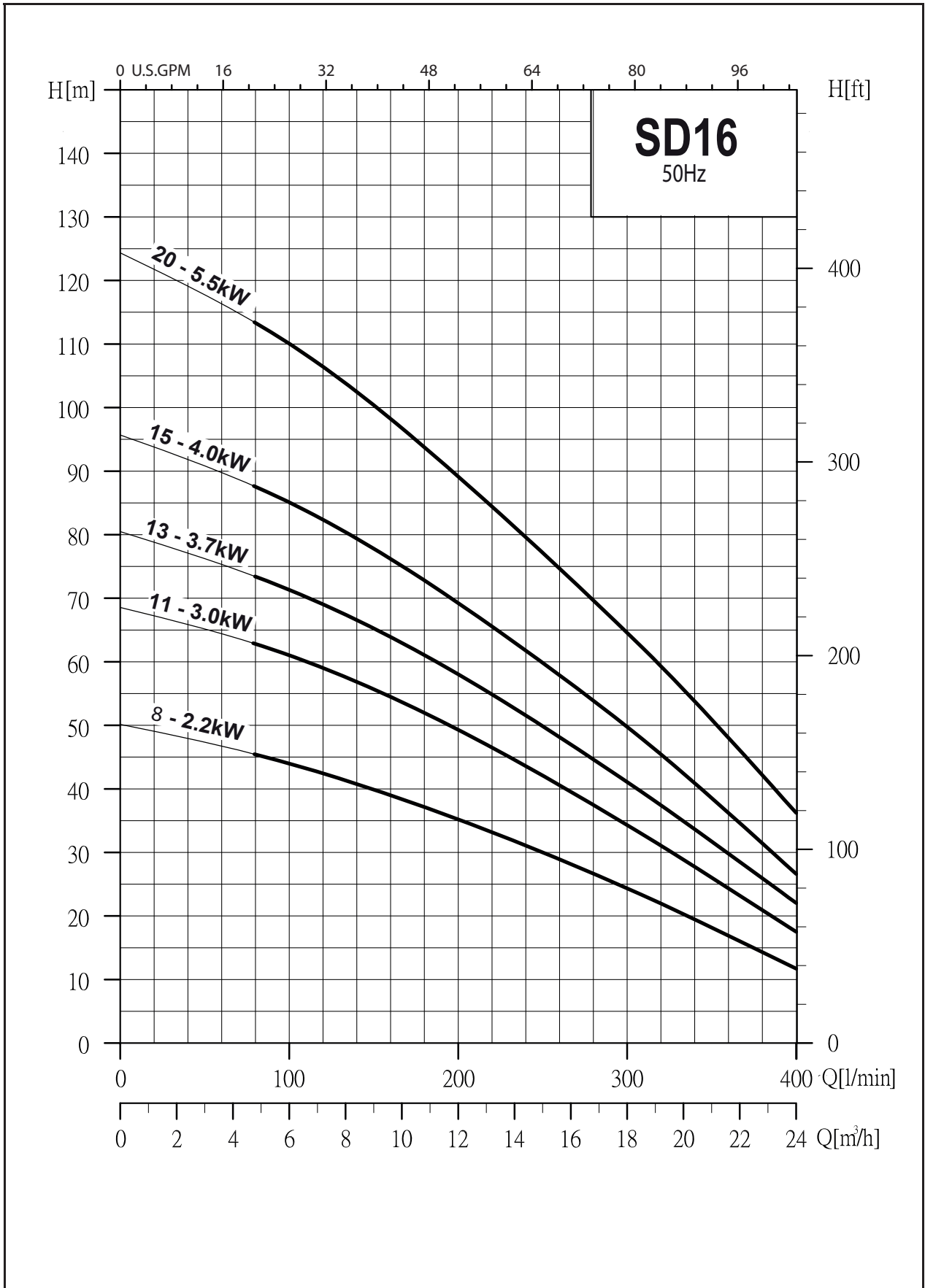

A division of Pentair Flow Control Pacific Pty Ltd A.B.N. 83 000 922 690

MODEL
SD16

“SD” Series
4 inch (100mm)
Submersible Borehole Pumps



TECHNICAL DATA

SD16 DIMENSIONS & WEIGHTS

MODEL	NO. OF STAGES	MOTOR		DIMENSIONS (mm)				MASS (kg)		
		kW	DIAM	A	B	C	D	PUMP	MOTOR	
With Single Phase SAVA Motors										
SD16-08	8	2.2	4"	1171	495	676	50mm (2") BSPF Pump Outlet	6.3	14.0	
With Three Phase SAVA Motors										
SD16-08	8	2.2	4"	1116	440	676		6.3	14.0	
SD16-11	11	3	4"	1396	516	880		8.1	15.2	
SD16-13	13	4	4"	1620	607	1013		9.3	19.5	
SD16-15	15	4	4"	1756	607	1149		1.5	19.5	
SD16-20	20	5.5	4"	2172	683	1489		13.5	23.1	

ELECTRICAL DATA 4 INCH MOTORS 240V 50Hz SINGLE PHASE & 415V 50Hz 3 PHASE

MOTOR kW	THRUST kg	FULL LOAD AMPS	NOMINAL RPM	LOCK ROTOR AMPS
4 INCH SAVA SINGLE PHASE MOTORS				
0.37	204	3.7	2840	12
0.55	204	4.3	2840	15
0.75	204	5.7	2840	20
1.1	204	7.8	2840	32
1.5	204	9.8	2850	38
2.2	306	15	2820	46
4 INCH SAVA 3 PHASE MOTORS				
0.37	204	1.2	2820	4.5
0.55	204	1.6	2830	6.7
0.75	204	2.1	2830	8.9
1.1	204	2.7	2840	12
1.5	204	3.6	2840	14
2.2	306	5.4	2840	22
3	510	7.5	2850	43
4	510	9.9	2855	49
5.5	510	13.8	2850	65

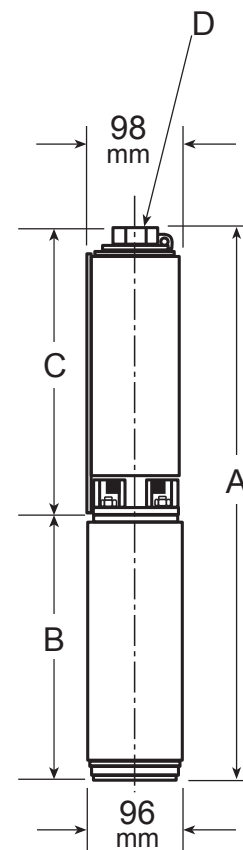



THIS PAGE IS INTENSIONALLY LEFT BLANK

