

PUMP DIMENSIONS

STARLINE MOTORPUMPS TECHNICAL DATA

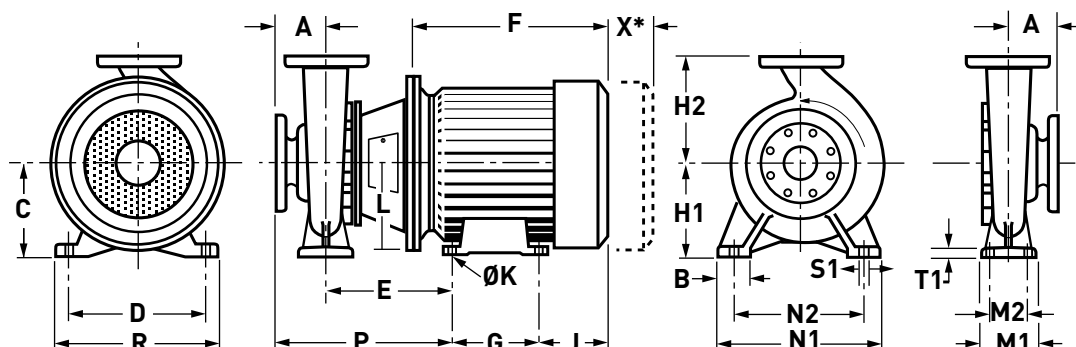

Pumps with **3500 RPM** (Nominal Speed) TEFC Motors

PUMP MODEL	SHAFT NO.	MOTOR HP	FRAME SIZE	PUMP DIMENSIONS (INCHES)																								WEIGHT (LB)
				INLET	OUTLET	IMP DIA	A	B	C	D	E	F	G	H1	H2	J	K	L	M1	M2	N1	N2	P	R	ST1	T1	GAP X*	
50x32-160 SEA	1	7.5	132S						5.20	8.50	10.67	14.65	5.51			5.63	0.47	5.91					13.82	9.76				209
		10	132S	2.00	1.25	6.25	3.15	1.97	5.20	8.50	10.67	14.65	5.51	5.20	6.30	5.63	0.47	5.91	3.94	2.76	9.45	7.48	13.82	9.76	0.55	0.47	3.94	224
		15	160M						6.30	10.00	12.80	19.21	8.27			6.69	0.59	6.89					16.73	12.13				328
65x50-160 SEB	1	10	132S						5.20	8.50	10.67	14.65	5.51			5.63	0.47	5.91					13.82	9.76				227
		15	160M	2.50	2.00	6.25	3.15	1.97	6.30	10.00	12.80	19.21	8.27	5.20	6.30	6.69	0.59	6.89	3.94	2.76	9.45	7.48	16.73	12.13	0.55	0.47	3.94	330
		20	160M						6.30	10.00	12.80	19.21	8.27			6.69	0.59	6.89					16.73	12.13				341
80x65-160 SEC	1	15	160M						6.30	10.00	12.80	19.21	8.27			6.69	0.59	6.89					16.73	12.13				341
		20	160M	3.00	2.50	6.25	3.94	1.97	6.30	10.00	12.80	19.21	8.27	6.30	7.09	6.69	0.59	6.89	3.94	2.76	10.43	8.35	16.73	12.60	0.55	0.51	3.94	352
		25	160L						6.30	10.00	12.80	20.94	10.00			6.69	0.59	6.89					16.73	12.13				398
		30	180M						7.09	10.98	13.35	21.81	9.49			7.56	0.59	6.89					17.28	13.78				495
100x80-160 SED	2	25	160L						6.30	10.00	12.95	20.94	10.00			6.69	0.59	6.89					16.89	12.13				444
		30	180M	4.00	3.00	6.25	3.94	2.56	7.09	10.98	13.46	21.81	9.49	6.30	7.87	7.56	0.59	6.89	4.92	3.74	11.02	8.35	17.40	13.78	0.55	0.55	3.94	495
		40	200L						7.87	12.52	13.94	25.87	12.01			8.62	0.75	7.87					17.87	15.16				667
		50	200L						7.87	12.52	13.94	25.87	12.01			8.62	0.75	7.87					17.87	15.16				702
50x32-200 SFA	1	15	160M						6.30	10.00	12.83	19.21	8.27			6.69	0.59	6.89					15.98	12.13				343
		20	160M	2.00	1.25	8.00	3.15	1.97	6.30	10.00	12.83	19.21	8.27	6.30	7.09	6.69	0.59	6.89	3.94	2.76	9.45	7.48	15.98	12.13	0.55	0.51	3.94	354
		25	160L						6.30	10.00	12.83	20.94	10.00			6.69	0.59	6.89					15.98	12.13				400
65x40-200 SFB	1	20	160M						6.30	10.00	12.83	19.21	8.27			6.69	0.59	6.89					16.77	12.13				356
		25	160L	2.50	1.50	8.00	3.94	1.97	6.30	10.00	12.83	20.94	10.00	6.30	7.09	6.69	0.59	6.89	3.94	2.76	10.43	8.35	16.77	12.13	0.55	0.51	3.94	403
		30	180M						7.09	10.98	13.35	21.81	9.49			7.56	0.59	6.89					17.28	13.78				499
80x50-200 SFC	1	30	180M	3.00	2.00	8.00	3.94	1.97	7.09	10.98	13.35	21.81	9.49	6.30	7.87	7.56	0.59	6.89	3.94	2.76	10.43	8.35	17.28	13.78	0.55	0.51	3.94	513
100x65-200 SFD	2	50	200L						7.87	12.52	13.94	25.87	12.01			8.62	0.75	7.87					17.87	15.16				702
		60	225M	4.00	2.50	8.00	3.94	2.56	8.86	14.02	14.57	27.83	11.26	7.09	8.86	10.71	0.75	8.86	4.92	3.74	12.60	9.84	18.50	17.17	0.55	0.59	5.51	1054
		75	250M						9.84	15.98	16.50	30.83	12.24			11.97	0.94	10.83					20.43	19.92				1267
		100	280S						11.02	17.99	16.50	35.28	14.49			13.31	0.94	10.83					20.43	21.93				1267
65x40-250 SGB	2	30	180M						7.09	10.98	13.46	21.81	9.49			7.56	0.59	6.89					17.40	13.78				537
		40	200L	2.50	1.50	10.00	3.94	2.56	7.87	12.52	13.94	25.87	12.01	7.09	8.86	8.62	0.75	7.87	4.92	3.74	12.60	9.84	17.87	15.16	0.55	0.55	3.94	675
		50	200L						7.87	12.52	13.94	25.87	12.01			8.62	0.75	7.87					17.87	15.16				717
		60	225M						8.86	14.02	14.57	27.83	11.26			10.71	0.75	8.86					18.50	17.17				1056
80x50-250 SGC	2	60	225M						8.86	14.02	14.57	27.83	11.26			10.71	0.75	8.86					19.49	17.17				832
		75	250M	3.00	2.00	10.00	4.92	2.56	9.84	15.98	16.50	30.83	12.24	7.09	8.86	11.97	0.94	10.83	4.92	3.74	12.60	9.84	21.42	19.92	0.55	0.59	3.94	1272
		100	280S						11.02	17.99	16.50	35.28	14.49			13.31	0.94	10.83					21.42	21.93				1272

* Gap necessary for the withdrawal or bearing housing, backplate and impeller assembly towards the drive end.

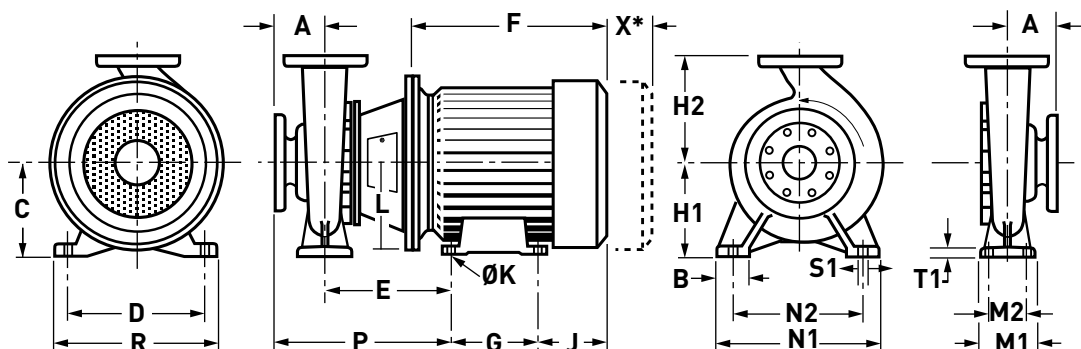

Pumps with **1780 RPM** (Nominal Speed) TEFC Motors

PUMP MODEL	SHAFT NO.	MOTOR HP	FRAME SIZE	PUMP DIMENSIONS (INCHES)																								WEIGHT (LB)
				INLET	OUTLET	IMP DIA	A	B	C	D	E	F	G	H1	H2	J	K	L	M1	M2	N1	N2	P	R	ST1	T1	GAP X*	
50x32-160 SEA	1	1	80	2.00	1.25	6.25	3.15	1.97	3.15	4.92	8.07	9.29	3.94	5.2	6.3	3.39	0.39	3.94	3.94	2.76	9.45	7.48	11.22	5.87	0.55	0.47	3.94	110
		1.5	90S						3.54	5.51	8.31	10	3.94			3.86	0.39	3.94					11.46	6.46				125
65x50-160 SEB	1	1.5	90S	2.50	2.00	6.25	3.15	1.97	3.54	5.51	8.31	10	3.94	5.2	6.3	3.86	0.39	3.94	3.94	2.76	9.45	7.48	11.46	6.46	0.55	0.47	3.94	121
		2	90L						3.54	5.51	8.31	10.98	4.92			3.86	0.39	3.94					11.46	6.46				132
80x65-160 SEC	1	2	90L						3.54	5.51	8.31	10.98	4.92			3.86	0.39	3.94					12.24	6.46				143
		3	100L	3.00	2.50	6.25	3.94	1.97	3.94	6.3	8.86	12.44	5.51	6.3	7.09	4.45	0.47	4.92	3.94	2.76	10.43	8.35	12.8	7.4	0.55	0.51	3.94	161
		4	100L						3.94	6.3	8.86	12.44	5.51			4.45	0.47	4.92					12.8	7.4				183
100x80-160 SED	2	3	100L						3.94	6.3	9.02	12.44	5.51			4.45	0.47	4.92					12.95	7.4				180
		4	100L	4.00	3.00	6.25	3.94	2.56	3.94	6.3	9.02	12.44	5.51	6.3	7.87	4.45	0.47	4.92	4.92	3.74	11.02	8.35	12.95	7.4	0.55	0.55	3.94	189
		5.5	112M						4.41	7.48	9.29	13.11	5.51			4.84	0.47	4.92					13.23	8.66				211
50x32-200 SFA	1	1.5	90S						3.54	5.51	8.31	10	3.94			3.86	0.39	3.94					11.46	6.46				134
		2	90L	2.00	1.25	8.00	3.15	1.97	3.54	5.51	8.31	10.98	4.92	6.3	7.09	3.86	0.39	3.94	3.94	2.76	9.45	7.48	11.46	6.46	0.55	0.51	3.94	145
		3	100L						3.94	6.3	8.86	12.44	5.51			4.45	0.47	4.92					12.01	7.4				163
65x40-200 SFB	1	3	100L	2.50	1.50	8.00	3.94	1.97	3.94	6.3	8.86	12.44	5.51	6.3	7.09	4.45	0.47	4.92	3.94	2.76	10.43	8.35	12.8	7.4	0.55	0.51	3.94	163
		4	100L						3.94	6.3	8.86	12.44	5.51			4.45	0.47	4.92					12.8	7.4				189
80x50-200 SFC	1	4	100L						3.94	6.3	8.86	12.44	5.51			4.45	0.47	4.92					12.8	7.4				185
		5.5	112M	3.00	2.00	8.00	3.94	1.97	4.41	7.48	9.13	13.11	5.51	6.3	7.87	4.84	0.47	4.92	3.94	2.76	10.43	8.35	13.07	8.66	0.55	0.51	3.94	205
		7.5	132S						5.2	8.5	10.67	14.65	5.51			5.63	0.47	5.91					14.61	9.76				251
100x65-200 SFD	2	5.5	112M						4.41	7.48	9.29	13.11	5.51			4.84	0.47	4.92					13.23	9.06				213
		7.5	132S	4.00	2.50	8.00	3.94	2.56	5.2	8.5	10.83	14.65	5.51	7.09	8.86	5.63	0.47	5.91	4.92	3.74	12.6	9.84	14.76	9.76	0.55	0.59	5.51	273
		10	132M						5.2	8.5	10.83	16.14	7.01			5.63	0.47	5.91					14.76	9.76				308
		15	160M						6.3	10	12.95	19.21	8.27			6.69	0.59	6.89					16.89	12.13				398
125x80-200 SFE	2	7.5	132S						5.2	8.5	10.79	15.35	5.51			5.63	0.47	5.91					15.71	9.76				290
		10	132M	5.00	3.00	8.00	4.92	2.56	5.2	8.5	10.79	16.14	7.01	7.09	9.84	5.63	0.47	5.91	4.92	3.74	13.58	11.02	15.71	9.76	0.55	0.63	5.51	319
		15	160M						6.3	10	12.95	19.21	8.27			6.69	0.59	6.89					17.87	12.13				416
125x100-200 SFF	2	10	132M						5.2	8.5	10.83	16.14	7.01			5.63	0.47	5.91					15.75	9.76				332
		15	160M	5.00	4.00	8.00	4.92	3.15	6.3	10	12.95	19.21	8.27	7.87	11.02	6.69	0.59	6.89	6.3	4.72	14.17	11.02	17.87	12.13	0.71	0.67	5.51	429
		20	160L						6.3	10	12.95	20.94	10			6.69	0.59	6.89					17.87	12.13				451
65x40-250 SGB	2	4	100L						3.94	6.3	9.02	12.8	5.51			4.45	0.47	4.92					12.95	8.07				209
		5.5	112M	2.50	1.50	10.00	3.94	2.56	4.41	7.48	9.29	13.11	5.51	7.09	8.86	4.84	0.47	4.92	4.92	3.74	12.6	9.84	13.23	8.66	0.55	0.55	3.94	227
		7.5	132S						5.2	8.5	10.83	14.65	5.51			5.63	0.47	5.91					14.76	9.76				273
80x50-250 SGC	2	7.5	132S						5.2	8.5	10.83	14.65	5.51			5.63	0.47	5.91					15.75	9.76				275
		10	132M	3.00	2.00	10.00	4.92	2.56	5.2	8.5	10.83	16.14	7.01	7.09	8.86	5.63	0.47	5.91	4.92	3.74	12.6	9.84	15.75	9.76	0.55	0.59	3.94	312
		15	160M						6.3	10	12.95	19.21	8.27			6.69	0.59	6.89					17.87	12.13				403

* Gap necessary for the withdrawal or bearing housing, backplate and impeller assembly towards the drive end.

PUMP DIMENSIONS

STARLINE
MOTORPUMPS
TECHNICAL DATA

Southern Cross
CENTRIFUGAL PUMP TECHNICAL DATA

Pumps with **1780 RPM** (Nominal Speed) TEFC Motors (CONTINUED)

PUMP MODEL	SHAFT NO.	MOTORHP	FRAME SIZE	PUMP DIMENSIONS (INCHES)																							WEIGHT (LB)
				INLET	OUTLET	IMP DIA	A	B	C	D	E	F	G	H1	H2	J	K	L	M1	M2	N1	N2	P	R	ST1	T1	
100x65-250 SGD	2	10	132M						5.2	8.5	10.83	16.14	7.01			5.63	0.47	5.91					15.75	9.76			326
		15	160M	4.00	2.50	10.00	4.92	3.15	6.3	10	12.95	19.21	8.27	7.87	9.84	6.69	0.59	6.89	6.3	4.72	14.17	11.02	17.87	12.13	0.71	0.63	422
		20	160L						6.3	10	12.95	20.94	10			6.69	0.59	6.89					17.87	12.13			444
125x80-250 SGE	2	15	160M						6.3	10	12.95	19.21	8.27			6.69	0.59	6.89					17.87	12.13			453
		20	160L	5.00	3.00	10.00	4.92	3.15	6.3	10	12.95	20.94	10	8.86	11.02	6.69	0.59	6.89	6.3	4.72	15.75	12.4	17.87	12.13	0.71	0.71	462
		25	180M						7.09	10.98	13.46	21.81	9.49			7.56	0.59	6.89					18.39	13.78			561
125x100-250 SGF	3	20	160L						6.3	10	13.74	20.94	10			6.69	0.59	6.89					19.25	12.13			537
		25	180M	5.00	4.00	10.00	5.51	3.15	7.09	10.98	14.25	21.81	9.49	8.86	11.02	7.56	0.59	6.89	6.3	4.72	15.75	12.4	19.76	13.78	0.71	0.71	609
		30	180L						7.09	10.98	14.25	23.31	10.98			7.56	0.59	6.89					19.76	13.78			653
		40	200L						7.87	12.52	14.72	25.87	12.01			8.62	0.75	7.87					20.24	15.16			757
150x125-250 SGG	3	25	180M						7.09	10.98	14.25	21.81	9.49			7.56	0.59	6.89					19.76	13.78			660
		30	180L	6.00	5.00	10.00	5.51	3.15	7.09	10.98	14.25	23.31	10.98	9.84	13.98	7.56	0.59	6.89	6.3	4.72	15.75	12.4	19.76	13.78	0.71	0.75	678
		40	200L						7.87	12.52	14.72	25.87	12.01			8.62	0.75	7.87					20.24	15.16			792
		50	225S						8.86	14.02	16.54	27.83	11.26			10.71	0.75	8.86					22.05	17.17			1078
65x40-315 SHB	2	7.5	132S						5.2	8.5	10.83	14.65	5.51			5.63	0.47	5.91					15.75	9.76			295
		10	132M	2.50	1.50	12.50	4.92	2.56	5.2	8.5	10.83	16.14	7.01	7.87	9.84	5.63	0.47	5.91	4.92	3.74	13.58	11.02	15.75	9.76	0.55	0.63	330
		15	160M						6.3	10	12.95	19.21	8.27			6.69	0.59	6.89					17.87	12.13			420
80x50-315 SHC	2	10	132M						5.2	8.5	10.83	16.93	7.01			5.63	0.47	5.91					15.75	9.76			332
		15	160M	3.00	2.00	12.50	4.92	2.56	6.3	10	12.95	19.21	8.27	8.86	11.02	6.69	0.59	6.89	4.92	3.74	13.58	11.02	17.87	12.13	0.55	0.71	429
		20	160L						6.3	10	12.95	20.94	10			6.69	0.59	6.89					17.87	12.13			451
100x65-315 SHD	3	20	160L						6.3	10	13.74	20.94	10			6.69	0.59	6.89					18.66	12.13			539
		25	180M	4.00	2.50	12.50	4.92	3.15	7.09	10.98	14.25	21.81	9.49	8.86	11.02	7.56	0.59	6.89	6.3	4.72	15.75	12.4	19.17	13.78	0.71	0.71	612
		30	180L						7.09	10.98	14.25	23.31	10.98			7.56	0.59	6.89					19.17	13.78			656
		40	200L						7.87	12.52	14.72	25.87	12.01			8.62	0.75	7.87					19.65	15.16			759
125x80-315 SHE	3	25	180M						7.09	10.98	14.25	21.81	9.49			7.56	0.59	6.89					19.17	13.78			642
		30	180L	5.00	3.00	12.50	4.92	3.15	7.09	10.98	14.25	23.31	10.98	9.84	12.4	7.56	0.59	6.89	6.3	4.72	15.75	12.4	19.17	13.78	0.71	0.79	675
		40	200L						7.87	12.52	14.72	25.87	12.01			8.62	0.75	7.87					19.65	13.78			779
125x100-315 SHF	3	30	180L						7.09	10.98	14.25	23.31	10.98			7.56	0.59	6.89					19.76	13.78			680
		40	200L	5.00	4.00	12.50	5.51	3.15	7.87	12.52	14.72	25.87	12.01	9.84	12.4	8.62	0.75	7.87	6.3	4.72	15.75	12.4	20.24	15.16	0.71	0.75	799
		50	225S						8.86	14.02	16.54	27.83	11.26			9.72	0.75	8.86					22.05	17.17			1082
150x125-315 SHG	3	50	225S						8.86	14.02	16.54	27.83	11.26			9.72	0.75	8.86					22.05	17.17			944
		60	225M	6.00	5.00	12.50	5.51	3.94	8.86	14.02	16.54	26.97	12.24	11.02	13.98	9.72	0.75	8.86	7.87	5.91	19.69	15.75	22.05	17.17	0.87	0.79	1023
		75	250M						9.84	15.98	17.28	30.83	13.74			10.47	0.94	10.83					22.8	19.92			1397
		100	280S						11.02	17.99	17.28	35.28	14.49			11.3	0.94	10.83					22.8	21.93			1498
200x150-315 SHH	4	60	225M						8.86	14.02	19.25	27.83	12.24			9.72	0.75	8.86					25.55	17.17			1305
		75	250M	8.00	6.00	12.50	6.3	3.94	9.84	15.98	20	30.83	13.74	12.4	15.75	10.47	0.94	10.83	8.27	5.91	21.26	17.72	26.3	19.92	0.87	0.79	1720
		100	280S						11.02	17.99	20	35.28	14.49			11.3	0.94	10.83					26.3	21.93			1822
		125	280M						11.02	17.99	22.05	35.28	16.5			11.3	0.94	10.83					28.35	21.93			2438
250x200-315 SHJ	4	100	280S						11.02	17.99	20.87	35.28	14.49			11.3	0.94	10.83					27.95	21.93			1925
		125	280M	10.00	8.00	12.50	7.09	3.94	11.02	17.99	22.05	35.28	16.5	12.4	17.72	11.3	0.94	10.83	8.27	5.91	21.26	17.72	29.13	21.93	0.87	0.98	2519
		150	280M						11.02	17.99	22.05	35.28	16.5			11.3	0.94	10.83					29.13	21.93			2660
		175	315S						12.4	20	23.07	38.82	17.99			12.32	1.1	12.99					30.16	24.72			2948
125x80-400 SJE	3	40	200L						7.87	12.52	14.72	25.87	12.01			8.62	0.75	7.87					19.65	15.16			926
		50	225S	5.00	3.00	16.00	4.92	3.15	8.86	14.02	16.54	27.83	11.26	11.02	13.98	9.72	0.75	8.86	6.3	4.72	17.13	13.98	21.46	17.17	0.71	0.79	1144
		60	225M						8.86	14.02	16.54	27.83	12.24			9.72	0.75	8.86					21.46	17.17			1228
		75	250M						9.84	15.98	17.28	30.83	13.74			10.47	0.94	10.83					22.2	19.92			1421

* Gap necessary for the withdrawal or bearing housing, backplate and impeller assembly towards the drive end.

Pumps with **1780 RPM** (Nominal Speed) TEFC Motors (CONTINUED)

PUMP MODEL	SHAFT NO.	MOTOR HP	FRAME SIZE	PUMP DIMENSIONS (INCHES)																							WEIGHT (LB)	
				INLET	OUTLET	IMP DIA	A	B	C	D	E	F	G	H1	H2	J	K	L	M1	M2	N1	N2	P	R	ST1	T1		GAP X*
125x100-400 SJF	3	60	225M						8.86	14.02	16.54	26.97	12.24			9.72	0.75	8.86					22.05	17.17				1067
		75	250M	5.00	4.00	16.00	5.51	3.94	9.84	15.98	17.28	30.83	13.74	11.02	13.98	10.47	0.94	10.83	7.87	5.91	19.69	15.75	22.8	19.92	0.87	0.79	5.51	1441
		100	280S						11.02	17.99	17.28	35.28	14.49			11.3	0.94	10.83					22.8	21.93				1542
150x125-400 SJG	3	100	280S						11.02	17.99	17.28	35.28	14.49			11.3	0.94	10.83					22.8	21.93				1582
		125	280M	6.00	5.00	16.00	5.51	3.94	11.02	17.99	19.49	35.28	16.5	12.4	15.75	11.3	0.94	10.83	7.87	5.91	19.69	15.75	25	21.93	0.87	0.83	5.51	2277
		150	280M						11.02	17.99	19.49	35.28	16.5			11.3	0.94	10.83					25	21.93				2418
		175	315M						12.4	20	20.51	38.82	17.99			12.32	1.1	12.99					26.02	24.72				2710
200x150-400 SJH	4	125	280M						11.02	17.99	20.87	35.28	16.5			11.3	0.94	10.83					27.17	21.93				2211
		150	280M	8.00	6.00	16.00	6.3	3.94	11.02	17.99	23.07	35.28	16.5			11.3	0.94	10.83	8.27	5.91	21.26	17.72	29.37	21.93	0.87	0.98	7.09	2944
		175	315M						12.4	20	23.07	38.82	17.99			12.32	1.1	12.99					29.37	24.72				3003
		200	315M						12.4	20	23.07	38.82	17.99			12.32	1.1	12.99					29.37	24.72				3021
		250	315M						12.4	20	23.07	38.82	17.99			12.32	1.1	12.99					29.37	24.72				3117
125x100-500 SKF	4	150	280M						11.02	17.99	23.07	35.28	16.5			11.3	0.94	10.83					29.37	21.93				3029
		175	315M	5.00	4.00	20.00	6.3	3.94	12.4	20	23.07	38.82	17.99	13.98	17.72	12.32	1.1	12.99	8.27	5.91	21.26	17.72	29.37	24.72	0.87	0.98	7.09	3040
		200	315M						12.4	20	23.07	38.82	17.99			12.32	1.1	12.99					29.37	24.72				3058
		250	315M						12.4	20	23.07	38.82	17.99			12.32	1.1	12.99					29.37	24.72				3155
150x125-500 SKG	4	175	315M						12.4	20	23.07	38.82	17.99			12.32	1.1	12.99					29.37	24.72				3302
		200	315M	6.00	5.00	20.00	6.3	3.94	12.4	20	23.07	38.82	17.99	13.98	17.72	12.32	1.1	12.99	8.27	5.91	21.26	17.72	29.37	24.72	0.87	0.98	7.09	3111
		250	315M						12.4	20	23.07	38.82	17.99			12.32	1.1	12.99					29.37	24.72				3208
		270	315M						12.4	20	23.07	38.82	17.99			12.32	1.1	12.99					29.37	24.72				3115
200x150-500 SKH	4	250	315M	8.00	6.00	20.00	6.3	3.94	12.4	20	23.07	38.82	17.99	15.75	19.69	12.32	1.1	12.99	8.27	5.91	21.26	17.72	29.37	24.72	0.87	0.98	7.09	3260
		270	315M						12.4	20	23.07	38.82	17.99			12.32	1.1	12.99					29.37	24.72				3168

* Gap necessary for the withdrawal or bearing housing, backplate and impeller assembly towards the drive end.

PUMP DIMENSIONS

STARLINE MOTORPUMPS TECHNICAL DATA

Southern Cross CENTRIFUGAL PUMP TECHNICAL DATA

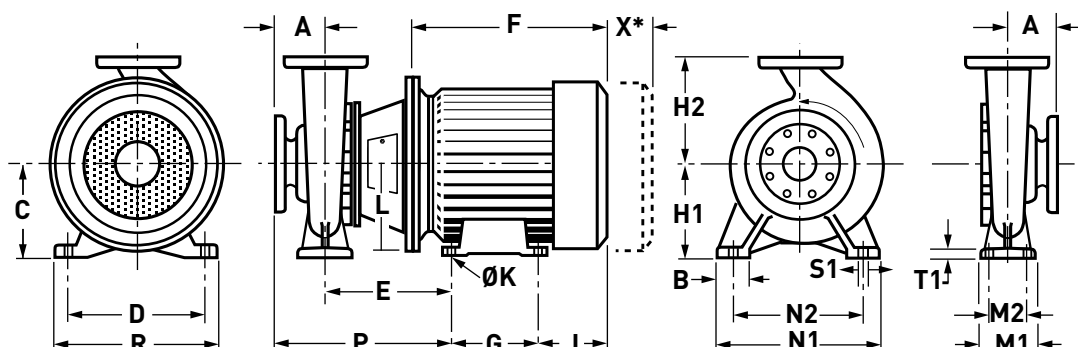

Pumps with 1170 RPM (Nominal Speed) TEFC Motors

PUMP MODEL	SHAFT NO.	MOTOR HP	FRAME SIZE	PUMP DIMENSIONS (INCHES)																							WEIGHT (LB)	
				INLET	OUTLET	IMP DIA	A	B	C	D	E	F	G	H1	H2	J	K	L	M1	M2	N1	N2	P	R	ST1	T1		GAP X*
200x150-315 SHH	4	20	180L						7.09	10.98	18.15	23.31	10.98			7.56	0.59	6.89					24.45	13.78				1030
		25	200L	8.00	6.00	12.50	6.30	3.94	7.87	12.52	18.62	25.87	12.01	12.40	15.75	8.62	0.75	7.87	8.27	5.91	21.26	17.72	24.92	15.16	0.87	0.79	7.09	1069
		30	200L						7.87	12.52	18.62	24.21	12.01			8.62	0.59	7.87					24.92	13.98				1155
		40	225M						8.86	14.02	19.25	27.83	12.24			9.72	0.75	8.86					25.55	17.17				1412
250x200-315 SHJ	4	30	200L						7.87	12.52	18.62	25.31	12.01			8.62	0.75	7.87					25.71	15.16				1239
		40	225M	10.00	8.00	12.50	7.09	3.94	8.86	14.02	19.25	27.83	12.24	12.40	17.72	9.72	0.75	8.86	8.27	5.91	21.26	17.72	26.34	17.17	0.87	0.98	7.09	1494
		50	250M						9.84	15.98	20.00	30.83	13.74			10.47	0.94	10.83					27.09	19.92				1727
125x80-400 SJE	3	15	160L						6.30	10.00	13.74	20.94	10.00			6.69	0.59	6.89					18.66	12.13				625
		20	180L	5.00	3.00	16.00	4.92	3.15	7.09	10.98	14.25	23.31	10.98	11.02	13.98	7.56	0.59	6.89	6.30	4.72	17.13	13.98	19.17	13.78	0.71	0.79	5.51	783
		25	180L						7.09	10.98	14.72	23.31	10.98			7.56	0.59	6.89					19.65	13.78				792
125x100-400 SJEF	3	20	180L						7.09	10.98	14.25	23.31	10.98			7.56	0.59	6.89					19.76	13.78				803
		25	200L	5.00	4.00	16.00	5.51	3.94	7.87	12.52	14.72	25.87	12.01	11.02	13.98	8.62	0.75	7.87	7.87	5.91	19.69	15.75	20.24	15.16	0.87	0.79	5.51	812
		30	200L						7.87	12.52	14.72	25.87	12.01			8.62	0.75	7.87					20.24	15.16				898
		40	225M						8.86	14.02	16.54	27.83	12.24			9.72	0.75	7.87					22.05	17.17				1166
150x125-400 SJG	3	30	200L						7.87	12.52	14.72	25.87	12.01			8.62	0.75	7.87					20.24	15.16				937
		40	225M	6.00	5.00	16.00			8.86	14.02	16.54	27.83	12.24			9.72	0.75	8.86					22.05	17.17				1206
		50	250M						9.84	15.98	17.28	30.83	13.74			10.47	0.94	10.83					22.80	19.92				1406
200x150-400 SJH	4	30	200L						7.87	12.52	18.62	25.87	12.01			9.72	0.75	7.87					24.92	15.16				1294
		40	225M	8.00	6.00	16.00	6.30	3.94	8.86	14.02	19.25	27.83	12.24	12.40	17.72	9.72	0.75	8.86	8.27	5.91	21.26	17.72	25.55	17.17	0.87	0.98	7.09	1386
		50	250M						9.84	15.98	20.00	30.83	13.74			10.47	0.94	10.83					26.30	19.92				1782
		60	250M						9.84	15.98	20.00	30.83	13.74			10.47	0.94	10.83					26.30	19.92				1870
125x100-500 SKF	4	50	250M						9.84	15.98	20.00	30.83	13.74			10.47	0.94	10.83					26.30	19.92				1727
		60	250M	5.00	4.00	20.00	6.30	3.94	9.84	15.98	20.00	30.83	13.74	13.98	17.72	10.47	0.94	10.83	8.27	5.91	21.26	17.72	26.30	19.92	0.87	0.98	7.09	1907
		75	250M						9.84	15.98	22.05	30.83	13.74			10.47	0.94	10.83					28.35	19.92				2275
150x125-500 SKG	4	50	250M						9.84	15.98	20.00	30.83	13.74			10.47	0.94	10.83					26.30	19.92				1780
		60	250M	6.00	5.00	20.00	6.30	3.94	9.84	15.98	20.00	30.83	13.74	13.98	17.72	10.47	0.94	10.83	8.27	5.91	21.26	17.72	26.30	19.92	0.87	0.98	7.09	1960
		75	280M						11.02	17.99	22.05	35.28	16.50			11.30	0.94	10.83					28.35	21.93				2328
		100	280M						11.02	17.99	22.05	35.28	16.50			11.30	0.94	10.83					28.35	21.93				2482
200x150-500 SKH	4	75	280M						11.02	17.99	20.87	35.28	16.50			11.30	0.94	10.83					27.17	21.93				2244
		100	280M	8.00	6.00	20.00	6.30	3.94	11.02	17.99	22.05	35.28	16.50	15.75	19.69	11.30	0.94	10.83	8.27	5.91	21.26	17.72	28.35	21.93	0.87	0.98	7.09	2534
		125	315M						12.40	20.00	23.07	38.82	17.99			12.32	1.10	12.99					29.37	24.72				2739

* Gap necessary for the withdrawal or bearing housing, backplate and impeller assembly towards the drive end.

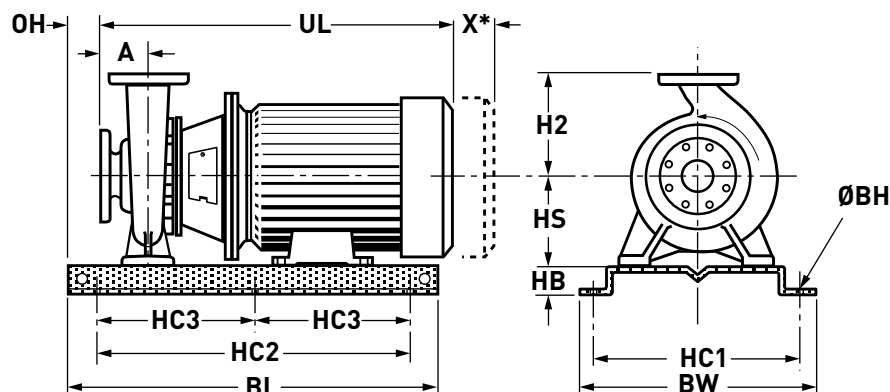

Pumps with **3500 RPM** (Nominal Speed) TEFC Motors and Pressed Steel Base Plates

PUMP MODEL	SHAFT NO.	MOTOR HP	FRAME SIZE	PUMP DIMENSIONS (INCHES)															WEIGHT (LB)	
				INLET	OUTLET	IMP DIA	BL	BW	HC1	HC2	HC3	HB	BH	OH	A	UL	HS	H2		GAP X*
50x32-160 SEA	1	7.5	132S				23.62	16.77	15.59	15.75	-	1.57	0.59			24.96	5.98			253
		10	132S	2.00	1.25	6.25	23.62	16.77	15.59	15.75	-	1.57	0.59	0.79	3.15	24.96	5.98	6.3	3.94	266
		15	160M				29.53	20.47	18.5	17.72	-	2.91	0.59			30.94	7.28			387
65x50-160 SEB	1	10	132S				23.62	16.77	15.59	15.75	-	1.57	0.59			24.96	5.98			268
		15	160M	2.50	2.00	6.25	29.53	20.47	18.5	17.72	-	2.91	0.59	0.79	3.15	30.94	7.28	6.3	3.94	389
		20	160M				35.43	22.52	20.55	23.62	-	3.66	0.59			30.94	7.28			429
80x65-160 SEC	1	15	160M				29.53	20.47	18.5	17.72	-	2.91	0.59			31.73	7.09			400
		20	160M	3.00	2.50	6.25	35.43	22.52	20.55	23.62	-	3.66	0.75	0.79	3.94	31.73	7.09	7.09	3.94	440
		25	160L				35.43	22.52	20.55	23.62	-	3.66	0.75			33.46	7.09			486
		30	180M				35.43	22.52	20.55	23.62	-	3.66	0.75			34.33	7.09			581
100x80-160 SED	2	25	160L				35.43	22.52	20.55	23.62	-	3.66	0.75			33.46	7.09			526
		30	180M	4.00	3.00	6.25	35.43	22.52	20.55	23.62	-	3.66	0.75	0.77	3.94	34.45	7.09	7.87	3.94	605
		40	200L				35.43	22.52	20.55	23.62	-	3.66	0.75			38.5	7.87			755
		50	200L				35.43	22.52	20.55	23.62	-	3.66	0.75			38.5	7.87			790
50x32-200 SFA	1	15	160M				29.53	20.47	18.5	17.72	-	2.91	0.59			30.94	6.3			411
		20	160M	2.00	1.25	8.00	35.43	22.52	20.55	23.62	-	3.66	0.75	0.79	3.15	30.94	6.3	7.09	3.94	442
		25	160L				35.43	22.52	20.55	23.62	-	3.66	0.75			32.68	7.09			488
65x40-200 SFB	1	20	160M				35.43	22.52	20.55	23.62	-	3.66	0.75			31.73	7.09			444
		25	160L	2.50	1.50	8.00	35.43	22.52	20.55	23.62	-	3.66	0.75	0.79	3.94	33.46	7.09	7.09	3.94	491
		30	180M				35.43	22.52	20.55	23.62	-	3.66	0.75			34.33	7.09			587
80x50-200 SFC	1	30	180M	3.00	2.00	8.00	35.43	22.52	20.55	23.62	-	3.66	0.75			34.33	7.09			601
100x65-200 SFD	2	40	200L				35.43	22.52	20.55	23.62	-	3.66	0.75			37.95	7.87			779
		60	225M	4.00	2.50	8.00	43.31	24.49	22.52	31.5	-	2.68	0.75	0.77	3.94	40.47	8.86	8.86	5.51	1157
		75	250M				43.31	24.49	22.52	31.5	-	2.68	0.75			44.65	11.02			1377
		100	280S				47.24	26.61	24.65	31.5	-	4.72	0.94			44.65	11.02			1443
65x40-250 SGB	2	30	180M				35.43	22.52	20.55	23.62	-	3.66	0.75			35.28	7.09			609
		40	200L	2.50	1.50	10.00	35.43	22.52	20.55	23.62	-	3.66	0.75	0.77	3.94	38.5	7.87	8.86	3.94	752
		50	200L				35.43	22.52	20.55	23.62	-	3.66	0.75			38.5				805
		60	225M				35.43	22.52	20.55	23.62	-	3.66	0.75			40.47				1142
80x50-250 SGC	2	60	225M				43.31	24.49	22.52	31.5	-	2.68	0.75			40.59	8.86			926
		75	250M	3.00	2.00	10.00	43.31	24.49	22.52	31.5	-	2.68	0.75	0.81	4.92	45.63		8.86	3.94	1382
		100	280S				47.24	26.61	24.65	31.5	-	4.72	0.94			45.63				1448

* Gap necessary for the withdrawal or bearing housing, backplate and impeller assembly towards the drive end.

PUMP DIMENSIONS

STARLINE

MOTORPUMPS
TECHNICAL DATA

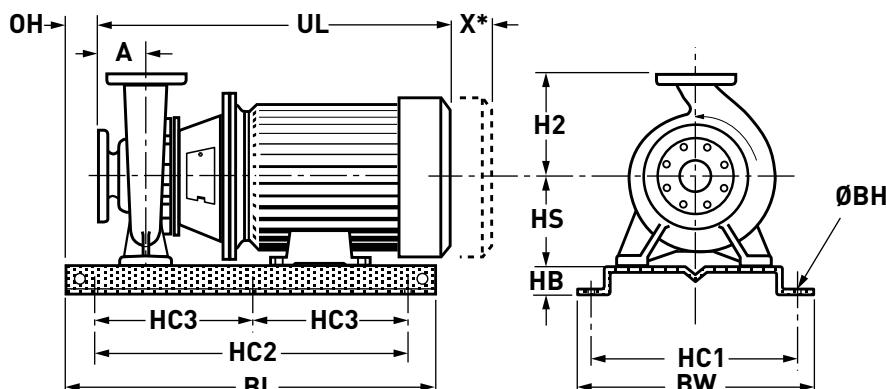

Pumps with **1780 RPM** (Nominal Speed) TEFC Motors and Pressed Steel Base Plates

PUMP MODEL	SHAFT NO.	MOTOR HP	FRAME SIZE	PUMP DIMENSIONS (INCHES)																WEIGHT (LB)
				INLET	OUTLET	IMP DIA	BL	BW	HC1	HC2	HC3	HB	BH	OH	A	UL	HS	H2	GAP X*	
50x32-160 SEA	1	1 1.5	80 90S	2.00	1.25	6.25	23.62 23.62	16.77 16.77	15.59 15.59	15.75 15.75	- -	1.57 1.57	0.59 0.59	0.79	3.15	18.54 19.25	5.2	6.3	3.94	141 169
65x50-160 SEB	1	1.5 2	90S 90L	2.50	2.00	6.25	23.62 23.62	16.77 16.77	15.59 15.59	15.75 15.75	- -	1.57 1.57	0.59 0.59	0.79	3.15	19.69 20.24	5.2	6.3	3.94	152 176
80x65-160 SEC	1	2 3 4	90L 100L 100L				23.62 23.62 23.62	16.77 16.77 16.77	15.59 15.59 15.59	15.75 15.75 15.75	- - -	1.57 1.57 1.57	0.59 0.59 0.59			21.46 22.76 22.76				176 205 227
100x80-160 SED	2	3 4 5.5	100L 100L 112M				23.62 23.62 23.62	16.77 16.77 16.77	15.59 15.59 15.59	15.75 15.75 15.75	- - -	1.57 1.57 1.57	0.59 0.59 0.59			23.27 23.27 23.58				218 227 253
50x32-200 SFA	1	1.5 2 3	90S 90L 100L				23.62 23.62 23.62	16.77 16.77 16.77	15.59 15.59 15.59	15.75 15.75 15.75	- - -	1.57 1.57 1.57	0.59 0.59 0.59			19.69 20.67 21.97				167 178 207
65x40-200 SFB	1	3 4	100L 100L	2.50	1.50	8.00	23.62 23.62	16.77 16.77	15.59 15.59	15.75 15.75	- -	1.57 1.57	0.59 0.59	0.79	3.94	23.11 22.76	6.3	7.09	3.94	200 233
80x50-200 SFC	1	4 5.5 7.5	100L 112M 132S				23.62 23.62 29.53	16.77 16.77 20.47	15.59 15.59 18.5	15.75 15.75 17.72	- - -	1.57 1.57 2.91	0.59 0.59 0.59			23.11 23.43 25.75				222 246 308
100x65-200 SFD	2	5.5 7.5 10 15	112M 132S 132M 160M				23.62 29.53 29.53 35.43	16.77 20.47 20.47 22.52	15.59 18.5 18.5 20.55	15.75 17.72 17.72 23.62	- - - -	1.57 2.91 2.91 3.66	0.59 0.59 0.59 0.75			23.86 26.61 27.4 31.85				251 323 365 486
125x80-200 SFE	2	7.5 10 15	132S 132M 160M				29.53 29.53 35.43	20.47 20.47 22.52	18.5 18.5 20.55	17.72 17.72 23.62	- - -	2.91 2.91 3.66	0.59 0.59 0.75			27.56 29.13 32.83				341 370 504
125x100-200 SFF	2	10 15 20	132M 160M 160L				29.53 35.43 35.43	20.47 22.52 22.52	18.5 20.55 20.55	17.72 23.62 23.62	- - -	2.91 3.66 3.66	0.59 0.75 0.75			29.17 32.83 34.57				385 517 539
65x40-250 SGB	2	4 5.5 7.5	100L 112M 132S				23.62 23.62 29.53	16.77 16.77 20.47	15.59 15.59 18.5	15.75 15.75 17.72	- - -	1.57 1.57 2.91	0.59 0.59 0.59			23.27 23.58 25.91				249 271 330
80x50-250 SGC	2	7.5 10 15	132S 132M 160M				29.53 29.53 35.43	20.47 20.47 22.52	18.5 18.5 20.55	17.72 17.72 23.62	- - -	2.91 2.91 3.66	0.59 0.59 0.75	0.81	4.92	27.6 28.39 32.83	7.09	8.86	3.94	328 370 491

* Gap necessary for the withdrawal or bearing housing, backplate and impeller assembly towards the drive end.



CENTRIFUGAL PUMP TECHNICAL DATA

STARLINEMOTORPUMPS
TECHNICAL DATA**PUMP
DIMENSIONS**Pumps with **1780 RPM** (Nominal Speed) TEFC Motors and Pressed
Steel Base Plates (CONTINUED)

PUMP MODEL	SHAFT NO.	MOTOR HP	FRAME SIZE	PUMP DIMENSIONS (INCHES)																WEIGHT (LB)
				INLET	OUTLET	IMP DIA	BL	BW	HC1	HC2	HC3	HB	BH	OH	A	UL	HS	H2	GAP X*	
100x65-250 SGD	2	10	132M				29.53	20.47	18.5	17.72	-	2.91	0.59			29.17				378
		15	160M	4.00	2.50	10.00	35.43	22.52	20.55	23.62	-	3.66	0.75	0.79	4.92	32.83	7.87	9.84	5.51	510
		20	160L				35.43	22.52	20.55	23.62	-	3.66	0.75			34.57				532
125x80-250 SGE	2	15	160M				35.43	22.52	20.55	23.62	-	3.66	0.75			33.5				535
		20	160L	5.00	3.00	10.00	35.43	22.52	20.55	23.62	-	3.66	0.75	0.79	4.92	34.57	8.86	11.02	5.51	649
		25	180M				35.43	22.52	20.55	23.62	-	3.66	0.75			35.43				695
125x100-250 SGF	3	20	160L				35.43	22.52	20.55	23.62	-	3.66	0.75			37.05				618
		25	180M	5.00	4.00	10.00	35.43	22.52	20.55	23.62	-	3.66	0.75	0.79	5.51	36.81	8.86	11.02	5.51	695
		30	180L				35.43	22.52	20.55	23.62	-	3.66	0.75			38.5				739
		40	200L				43.31	24.49	22.52	31.5	-	2.68	0.75			40.87				860
150x125-250 SGG	3	25	180M				35.43	22.52	20.55	23.62	-	3.66	0.75			37.64				741
		30	180L	6.00	5.00	10.00	35.43	22.52	20.55	23.62	-	3.66	0.75	0.79	5.51	39.21	9.84	13.98	5.51	759
		40	200L				43.31	24.49	22.52	31.5	-	2.68	0.75			40.87				900
		50	225S				43.31	24.49	22.52	31.5	-	2.68	0.75			44.02				1181
65x40-315 SHB	2	7.5	132S				29.53	20.47	18.5	17.72	-	2.91	0.59			27.6				348
		10	132M	2.50	1.50	12.50	29.53	20.47	18.5	17.72	-	2.91	0.59	0.81	4.92	28.39	7.87	9.84	3.94	389
		15	160M				35.43	22.52	20.55	23.62	-	3.66	0.75			32.83				508
80x50-315 SHC	2	10	132M				29.53	20.47	18.5	17.72	-	2.91	0.59			29.17				389
		15	160M	3.00	2.00	12.50	35.43	22.52	20.55	23.62	-	3.66	0.75	0.81	4.92	32.83	8.86	11.02	3.94	517
		20	160L				35.43	22.52	20.55	23.62	-	3.66	0.75			34.57				539
100x65-315 SHD	3	20	160L				35.43	22.52	20.55	23.62	-	3.66	0.75			36.46				620
		25	180M	4.00	2.50	12.50	35.43	22.52	20.55	23.62	-	3.66	0.75	0.79	4.92	36.22	8.86	11.02	5.51	697
		30	180L				35.43	22.52	20.55	23.62	-	3.66	0.75			37.72				741
		40	200L				43.31	24.49	22.52	31.5	-	2.68	0.75			40.28				862
125x80-315 SHE	3	25	180M				35.43	22.52	20.55	23.62	-	3.66	0.75			37.05				724
		30	180L	5.00	3.00	12.50	35.43	22.52	20.55	23.62	-	3.66	0.75	0.79	4.92	37.72	9.84	12.4	5.51	763
		40	200L				43.31	24.49	22.52	31.5	-	2.68	0.75			40.28				884
125x100-315 SHF	3	30	180L				35.43	22.52	20.55	23.62	-	3.66	0.75			39.21				761
		40	200L	5.00	4.00	12.50	43.31	24.49	22.52	31.5	-	2.68	0.75	0.79	5.51	40.87	9.84	12.4	5.51	904
		50	225S				43.31	24.49	22.52	31.5	-	2.68	0.75			44.02				1188
150x125-315 SHG	3	50	225S				43.31	24.49	22.52	31.5	-	2.68	0.75			42.17				1043
		60	225M	6.00	5.00	12.50	43.31	24.49	22.52	31.5	-	2.68	0.75	0.79	5.51	43.15	11.02	13.98	5.51	1129
		75	250M				43.31	24.49	22.52	31.5	-	2.68	0.75			47.01				1503
		100	250M				47.24	26.61	24.65	31.5	-	4.72	0.94			47.01				1670
200x150-315 SHH	4	60	225M				47.24	26.61	24.65	31.5	-	4.72	0.94			46.65				1476
		75	250M	8.00	6.00	12.50	47.24	26.61	24.65	31.5	-	4.72	0.94	0.79	6.3	50.51	12.4	15.75	7.09	1896
		100	250M				47.24	26.61	24.65	31.5	-	4.72	0.94			50.51				1998
		125	280M				59.06	30.51	28.54	43.31	21.65	4.72	0.94			56.14				2869
250x200-315 SHJ	4	100	250M				47.24	26.61	24.65	31.5	-	4.72	0.94			52.87				2101
		125	280M	10.00	8.00	12.50	59.06	30.51	28.54	43.31	21.65	4.72	0.94	0.79	7.09	56.93	12.4	17.72	7.09	2950
		150	280M				59.06	30.51	28.54	43.31	21.65	4.72	0.94			56.93				3091
		175	315M				59.06	30.51	28.54	43.31	21.65	4.72	0.94			60.47				3386
125x80-400 SJE	3	40	200L				43.31	24.49	22.52	31.5	-	2.68	0.75			39.72				1032
		50	225S	5.00	3.00	16.00	43.31	24.49	22.52	31.5	-	2.68	0.75	0.79	4.92	43.43	11.02	13.98	5.51	1250
		60	225M				43.31	24.49	22.52	31.5	-	2.68	0.75			43.43				1333
		75	250M				43.31	24.49	22.52	31.5	-	2.68	0.75			46.42				1527

* Gap necessary for the withdrawal or bearing housing, backplate and impeller assembly towards the drive end.

PUMP DIMENSIONS

STARLINE
MOTORPUMPS
TECHNICAL DATA

Southern Cross
CENTRIFUGAL PUMP TECHNICAL DATA

Pumps with **1780 RPM** (Nominal Speed) TEFC Motors and Pressed Steel Base Plates (CONTINUED)

PUMP MODEL	SHAFT NO.	MOTOR HP	FRAME SIZE	PUMP DIMENSIONS (INCHES)																WEIGHT (LB)
				INLET	OUTLET	IMP DIA	BL	BW	HC1	HC2	HC3	HB	BH	OH	A	UL	HS	H2	GAP X*	
125x100-400 SJF	3	60	225M				43.31	24.49	22.52	31.5	-	2.68	0.75			43.15				1173
		75	250M	5.00	4.00	16.00	5.51	3.94	22.52	31.5	-	2.68	0.75	0.79	5.51	47.01	11.02	13.98	5.51	1547
		100	250M						24.65	31.5	-	4.72	0.94			47.01				1714
150x125-400 SJG	3	100	250M						24.65	31.5	-	4.72	0.94			47.01				1756
		125	280M	6.00	5.00	16.00	5.51	3.94	24.65	31.5	-	4.72	0.94	0.79	5.51	52.8	12.4	15.75	5.51	2449
		150	280M						28.54	43.31	21.65	4.72	0.94			52.8				2849
		175	315M						28.54	43.31	21.65	4.72	0.94			56.34				3148
200x150-400 SJH	4	125	280M						24.65	31.5	-	4.72	0.94			54.09				2387
		150	280M	8.00	6.00	16.00	6.3	3.94	28.54	43.31	21.65	4.72	0.94			58.35				3373
		175	315M						28.54	43.31	21.65	4.72	0.94	0.79	6.3	59.69	12.4	17.72	7.09	3441
		200	315M						28.54	43.31	21.65	4.72	0.94			59.69				3458
		250	315M						28.54	43.31	21.65	4.72	0.94			59.69				3555
125x100-500 SKF	4	150	280M						28.54	43.31	21.65	4.72	0.94			59.69				3469
		175	315M	5.00	4.00	20.00	6.3	3.94	28.54	43.31	21.65	4.72	0.94	0.79	6.3	59.69	13.98	17.72	7.09	3474
		200	315M						28.54	43.31	21.65	4.72	0.94			59.69				3491
		250	315M						28.54	43.31	21.65	4.72	0.94			59.69				3588
150x125-500 SKG	4	175	315M						28.54	43.31	21.65	4.72	0.94			59.69				3742
		200	315M	6.00	5.00	20.00	6.3	3.94	28.54	43.31	21.65	4.72	0.94	0.79	6.3	59.69	13.98	17.72	7.09	3544
		250	315M						28.54	43.31	21.65	4.72	0.94			59.69				3641
		270	315M						28.54	43.31	21.65	4.72	0.94			59.69				3549
200x150-500 SKH	4	250	315M	8.00	6.00	20.00	6.3	3.94	28.54	43.31	21.65	4.72	0.94	0.79	6.3	59.69	15.75	19.69	7.09	3700
		270	315L				59.06	30.51	28.54	43.31	21.65	4.72	0.94			59.69				3608

* Gap necessary for the withdrawal or bearing housing, backplate and impeller assembly towards the drive end.

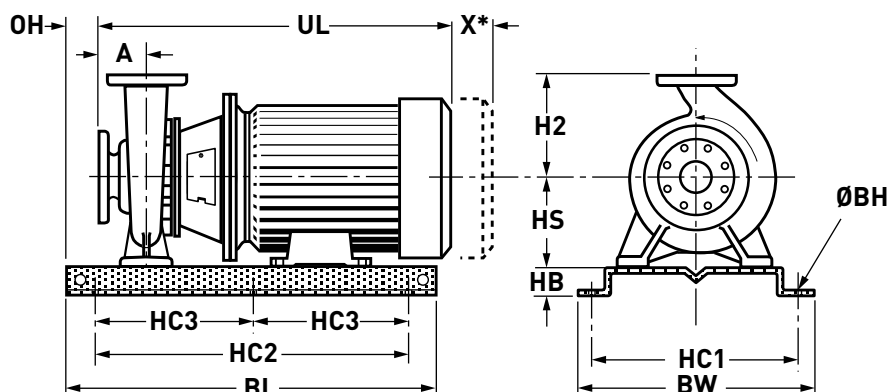

Pumps with **1170 RPM** (Nominal Speed) TEFC Motors and Pressed Steel Base Plates

PUMP MODEL	SHAFT NO.	MOTOR HP	FRAME SIZE	PUMP DIMENSIONS (INCHES)															WEIGHT (LB)	
				INLET	OUTLET	IMP DIA	BL	BW	HC1	HC2	HC3	HB	BH	OH	A	UL	HS	H2		GAP X*
200x150-315 SHH	4	20	180L	8.00	6.00	12.50	47.24	26.61	24.65	31.5	-	4.72	0.94	0.79	6.3	43.9	12.4	15.75	7.09	1203
		25	200L				47.24	26.61	24.65	31.5	-	4.72	0.94	0.79	6.3	45.55				1245
		30	200L				47.24	26.61	24.65	31.5	-	4.72	0.94	0.79	6.3	45.55				1331
		40	225M				47.24	26.61	24.65	31.5	-	4.72	0.94	0.79	6.3	47.52				1588
250x200-315 SHJ	4	30	200L	10.00	8.00	12.50	47.24	26.61	24.65	31.5	-	4.72	0.94	0.79	7.09	45.79	12.4	17.72	7.09	1410
		40	225M				47.24	26.61	24.65	31.5	-	4.72	0.94	0.79	7.09	48.31				1670
		50	225S				47.24	26.61	24.65	31.5	-	4.72	0.94	0.79	7.09	51.3				1903
125x80-400 SJE	3	15	160L	5.00	3.00	16.00	35.43	22.52	20.55	23.62	-	3.66	0.75	0.79	4.92	35.35	11.02	13.98	5.51	715
		20	180L				35.43	22.52	20.55	23.62	-	3.66	0.75	0.79	4.92	37.72				873
		25	200L				43.31	24.49	22.52	31.5	-	2.68	0.75	0.79	4.92	40.28				900
125x100-400 SJEF	3	20	180L	5.00	4.00	16.00	43.31	24.49	22.52	31.5	-	2.68	0.75	0.79	5.51	38.31	11.02	13.98	5.51	911
		25	200L				43.31	24.49	22.52	31.5	-	2.68	0.75	0.79	5.51	40.87				920
		30	200L				43.31	24.49	22.52	31.5	-	2.68	0.75	0.79	5.51	40.87				1005
		40	225M				43.31	24.49	22.52	31.5	-	2.68	0.75	0.79	5.51	44.02				1272
150x125-400 SJG	3	30	200L	6.00	5.00	16.00	43.31	24.49	22.52	31.5	-	2.68	0.75	0.79	5.51	40.87				1047
		40	225M				43.31	24.49	22.52	31.5	-	2.68	0.75	0.79	5.51	44.02				1313
		50	250M				43.31	24.49	22.52	31.5	-	2.68	0.75	0.79	5.51	47.01				1514
200x150-400 SJH	4	30	200L	8.00	6.00	16.00	47.24	26.61	24.65	31.5	-	4.72	0.94	0.79	6.3	45	12.4	17.72	7.09	1465
		40	225M				47.24	26.61	24.65	31.5	-	4.72	0.94	0.79	6.3	46.65				1555
		50	250M				47.24	26.61	24.65	31.5	-	4.72	0.94	0.79	6.3	50.51				1958
		60	250M				47.24	26.61	24.65	31.5	-	4.72	0.94	0.79	6.3	50.51				2046
		75	280M				47.24	26.61	24.65	31.5	-	4.72	0.94	0.79	6.3	56.14				2669
125x100-500 SKF	4	50	250M	5.00	4.00	20.00	47.24	26.61	24.65	31.5	-	4.72	0.94	0.79	6.3	49.13	13.98	17.72	7.09	1894
		60	250M				47.24	26.61	24.65	31.5	-	4.72	0.94	0.79	6.3	50.51				2086
		75	280M				47.24	26.61	24.65	31.5	-	4.72	0.94	0.79	6.3	56.14				2710
150x125-500 SKG	4	50	250M	6.00	5.00	20.00	47.24	26.61	24.65	31.5	-	4.72	0.94	0.79	6.3	49.13	13.98	17.72	7.09	1947
		60	250M				47.24	26.61	24.65	31.5	-	4.72	0.94	0.79	6.3	50.51				2138
		75	280M				47.24	26.61	24.65	31.5	-	4.72	0.94	0.79	6.3	56.14				2763
		100	280M				47.24	26.61	24.65	31.5	-	4.72	0.94	0.79	6.3	56.14				2917
200x150-500 SKH	4	75	280M	8.00	6.00	20.00	47.24	26.61	24.65	31.5	-	4.72	0.94	0.79	6.3	54.09	15.75	19.69	7.09	2409
		100	280M				47.24	26.61	24.65	31.5	-	4.72	0.94	0.79	6.3	56.14				2974
		125	315M				47.24	26.61	24.65	31.5	-	4.72	0.94	0.79	6.3	59.69				3179

* Gap necessary for the withdrawal or bearing housing, backplate and impeller assembly towards the drive end.

IMPELLER CLEARANCES

STARLINE
MOTORPUMPS
TECHNICAL DATA

Southern Cross
CENTRIFUGAL PUMP TECHNICAL DATA

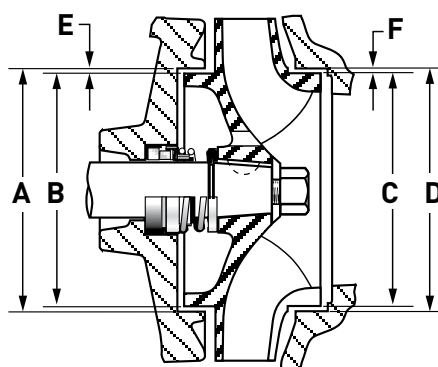

PUMP SIZE	IMPELLER AND CASING SEALING DIAMETERS						RADIAL CLEARANCE			
	A	B		C		D	E		F	
		CI/ZF	SS	CI/ZF	SS		CI/ZF	SS	CI/ZF	SS
50 x 32-160 65 x 50-160	3.624	3.613	3.607	3.613	3.607	3.624	0.005	0.007	0.005	0.007
	3.622	3.611	3.606	3.611	3.606	3.622	0.007	0.009	0.007	0.009
80 x 65-160	3.624	3.613	3.607	4.123	4.117	4.136	0.005	0.007	0.006	0.008
	3.622	3.611	3.606	4.121	4.115	4.134	0.007	0.009	0.007	0.010
100x 80-160	5.199	5.184	5.178	5.184	5.178	5.199	0.006	0.009	0.006	0.009
	5.197	5.181	5.175	5.181	5.175	5.197	0.009	0.012	0.009	0.012
50 x 32-200 65 x 40-200	4.136	4.123	4.117	3.613	3.607	3.624	0.006	0.008	0.005	0.007
	4.134	4.121	4.115	3.611	3.606	3.622	0.007	0.010	0.007	0.009
80 x 50-200	4.136	4.123	4.117	4.123	4.117	4.136	0.006	0.008	0.006	0.008
	4.134	4.121	4.115	4.121	4.115	4.134	0.007	0.010	0.007	0.010
100 x 65-200	5.199	5.184	5.178	5.184	5.178	5.199	0.006	0.009	0.006	0.009
	5.197	5.181	5.175	5.181	5.175	5.197	0.009	0.012	0.009	0.012
125 x 80-200 125 x 100-200	6.301	6.286	6.279	6.286	6.279	6.301	0.007	0.010	0.007	0.010
	6.299	6.283	6.276	6.283	6.276	6.299	0.009	0.012	0.009	0.012
65 x 40-250 80 x 50-250	4.530	4.516	4.510	4.516	4.510	4.530	0.006	0.009	0.006	0.009
	4.528	4.514	4.508	4.514	4.508	4.528	0.008	0.011	0.008	0.011
100 x 65-250	5.199	5.184	5.178	5.184	5.178	5.199	0.006	0.009	0.006	0.009
	5.197	5.181	5.175	5.181	5.175	5.197	0.009	0.012	0.009	0.012
125 x 80-250	5.199	5.184	5.178	6.286	6.279	6.301	0.006	0.009	0.007	0.010
	5.197	5.181	5.175	6.283	6.276	6.299	0.009	0.012	0.009	0.012
65 x 40-315	4.530	4.516	4.510	4.123	4.117	4.136	0.006	0.009	0.006	0.008
	4.528	4.514	4.508	4.121	4.115	4.134	0.008	0.011	0.007	0.010
80 x 50-315	4.530	4.516	4.510	4.516	4.510	4.530	0.006	0.009	0.006	0.009
	4.528	4.514	4.508	4.514	4.508	4.528	0.008	0.011	0.008	0.011
125 x 100-250 150 x 125-250	7.325	7.309	7.302	7.309	7.302	7.325	0.007	0.010	0.007	0.010
150 x 125-315 125 x 80-400	7.323	7.307	7.300	7.307	7.300	7.323	0.009	0.013	0.009	0.013
125 x 100-400 150 x 125-400										
100 x 65-315 125 x 80-315	6.301	6.286	6.279	6.286	6.279	6.301	0.007	0.010	0.007	0.010
	6.299	6.283	6.276	6.283	6.276	6.299	0.009	0.012	0.009	0.012
125 x 100-315	10.459	10.437	10.432	9.256	9.249	9.275	0.009	0.012	0.009	0.012
	10.457	10.435	10.430	9.253	9.247	9.273	0.012	0.015	0.011	0.014
200 x 150-315	10.459	10.437	10.432	10.437	10.432	10.459	0.009	0.012	0.009	0.012
	10.457	10.435	10.430	10.435	10.430	10.457	0.012	0.015	0.012	0.015
250 x 200-315	9.275	9.256	9.249	6.696	6.689	6.713	0.009	0.012	0.007	0.011
	9.273	9.253	9.247	6.694	6.687	6.711	0.011	0.014	0.009	0.013
125 x 100-500	9.275	9.256	9.249	7.878	7.870	7.896	0.009	0.012	0.007	0.011
	9.273	9.253	9.247	7.876	7.868	7.893	0.011	0.014	0.010	0.014
150 x 125-500 200x150-500	9.275	9.256	9.249	9.256	9.249	9.275	0.009	0.012	0.009	0.012
	9.273	9.253	9.247	9.253	9.247	9.273	0.011	0.014	0.011	0.014
200x150-400	9.275	9.256	9.249	9.256	9.249	9.275	0.009	0.012	0.009	0.012
	9.273	9.253	9.247	9.253	9.247	9.273	0.011	0.014	0.011	0.014

Machining Sizes to Retrofit Wear Rings to Casings and Impellers

NOMINAL SIZE (Inches)	IMPELLER WEAR RING	IMPELLER TURN SIZE (Inches)	CASING WEAR RING	CASING BORE SIZE (Inches)
3.62	SEA026	Ø 3.34/3.338	SEA027	Ø 3.898/3.899
4.13	SEC026	Ø 3.852/3.85	SEC027	Ø 4.409/4.411
4.53	SGB026	Ø 4.205/4.203	SGB027	Ø 4.843/4.844
5.20	SED026	Ø 4.873/4.871	SED027	Ø 5.512/5.513
6.30	SFF026	Ø 5.975/5.974	SFF027	Ø 6.614/6.616
6.69	SKF026	Ø 6.224/6.222	SKF027	Ø 7.183/7.185
7.28	SGF026	Ø 6.999/6.997	SGF027	Ø 7.638/7.639
7.87	SKG026	Ø 7.406/7.404	SKG027	Ø 8.287/8.289
9.25	SHH026	Ø 8.783/8.781	SHH027	Ø 9.746/9.748
10.43	SHJ026	Ø 9.965/9.963	SHJ027	Ø 10.93/10.932

FLANGE DIMENSIONS

STARLINE
MOTORPUMPS
TECHNICAL DATA

Southern Cross
CENTRIFUGAL PUMP TECHNICAL DATA

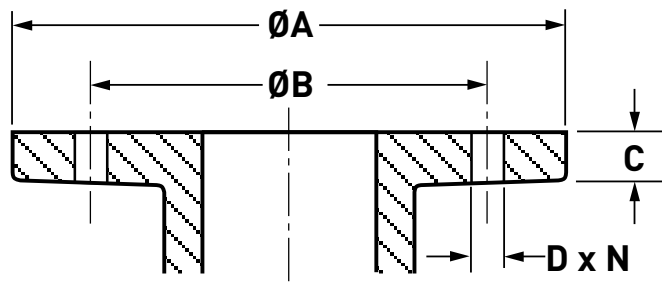

NOMINAL FLANGE SIZE		32	40	50	65	80	100*	125*	150*	200*	250*
FLANGE DIAMETER	A	140	150	165	185	200	220	250	285	340	405
HOLE P.C.D.	B	87	98	114	127	146	178	210	235	292	356
FLANGE THICKNESS	C	18	18	20	20	22	24	26	26	30	32
HOLE DIAMETER	D	14	14	18	18	18	18	18	22	22	22
NUMBER OF HOLES	N	4	4	4	4	4	8	8	8	8	12

NOTE:

1. Holes machined off centre lines.
2. Flange drilling as shown below conforms to AS2129 - 1982 Table 'E' for cast iron flanges.
3. Flange drilling to ANSI B16.1.1975 Class 125 (ISO7005 - PN20) PN16 are available options.

* Discharge flanges on No. 4 shaft pumps are tapped as follows:

125x100-500 and 150x125-500 tapped M16 x 2mm

200x150-315, 200x150-400, 200x150-500 and 250x200-315 tapped M20 x 2.5mm

		DIMENSIONS (Inches)									
NOMINAL FLANGE SIZE		1.26	1.57	1.97	2.56	3.15	3.94	4.92	5.91	7.87	9.84
FLANGE DIAMETER	A	5.51	5.91	6.50	7.28	7.87	8.66	9.84	11.22	13.39	15.94
HOLE P.C.D.	B	3.43	3.86	4.49	5.00	5.75	7.01	8.27	9.25	11.50	14.02
FLANGE THICKNESS	C	0.71	0.71	0.79	0.79	0.87	0.94	1.02	1.02	1.18	1.26
HOLE DIAMETER	D	0.55	0.55	0.71	0.71	0.71	0.71	0.71	0.87	0.87	0.87
NUMBER OF HOLES	N	0.16	0.16	0.16	0.16	0.16	0.31	0.31	0.31	0.31	0.47



CENTRIFUGAL PUMP TECHNICAL DATA

STARLINE

MOTORPUMPS
TECHNICAL DATA

**SECTIONAL
ARRANGEMENT**

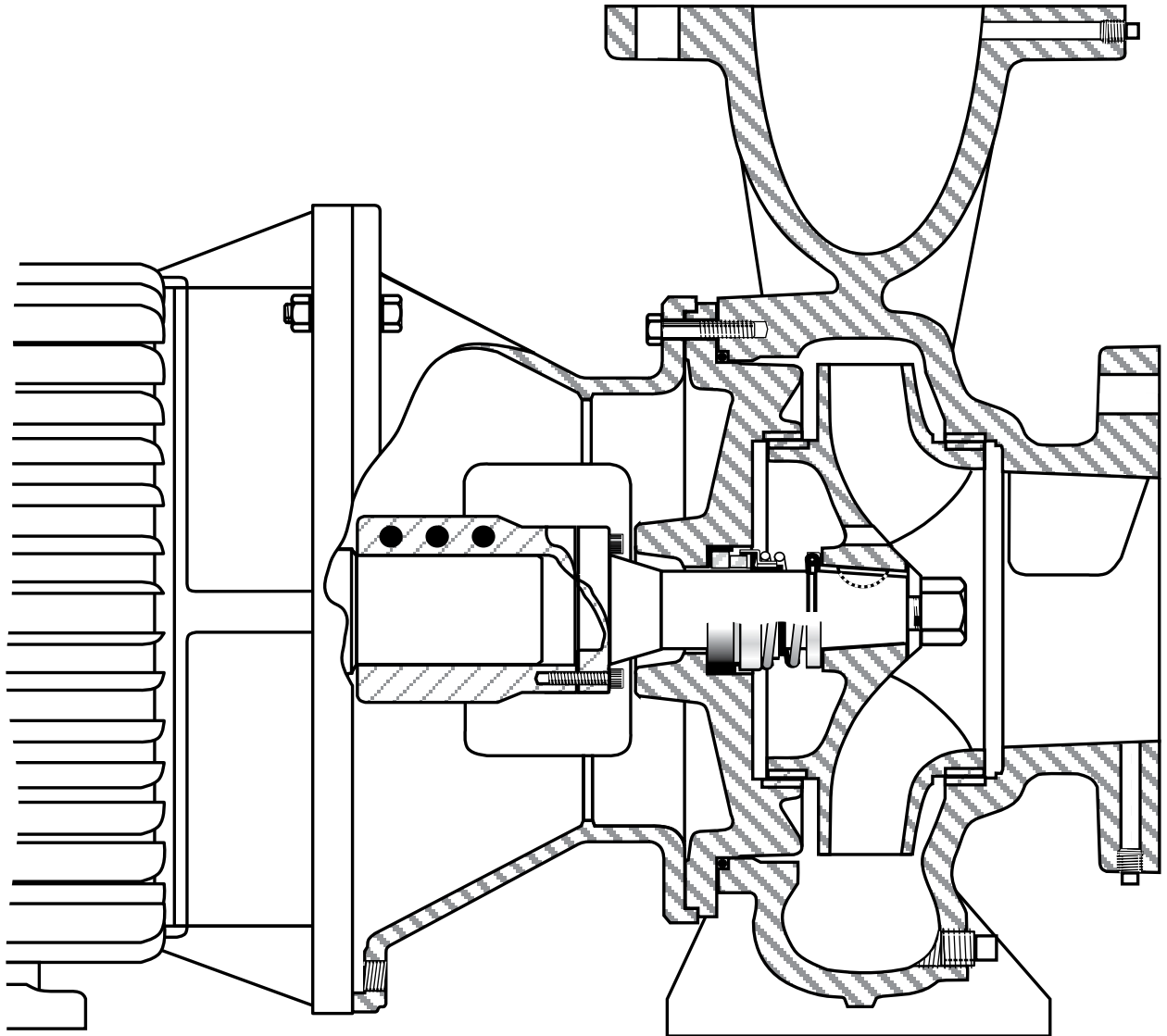

MISC. PUMP DATA

STARLINE

MOTORPUMPS
TECHNICAL DATA



CENTRIFUGAL PUMP TECHNICAL DATA

PUMP SIZE	CI IMPELLER (lbs)	IMPELLER ROTATIONAL INERTIA (lbs.inch ²)	MIN. CASING THICKNESS (inches)	CI / ZF IMPELLER		SHAFT CRITICAL SPEED (r.p.m.)	MAX OPERATING SPEED (r.p.m.)	IMPELLER	
				HYDROSTATIC TEST PRESSURE (psi)	MAX. WORKING PRESSURE (psi)##			No. of VANES	MAX SPHERE SIZE (inches)
50 x 32 - 160	5.95	27.3	0.354	550.7	362.3	14,600	3600	6	0.20
65 x 50 - 160	5.73	27.3	0.354	550.7	362.3	14,600	3600	6	0.28
80 x 65 - 160	6.17	34.2	0.394	550.7	362.3	14,600	3600	6	0.43
100 x 80 - 160	9.26	47.8	0.394	550.7	362.3	16,700	3600	6	0.47
50 x 32 - 200	8.16	61.5	0.354	478.3	318.8	12,400	3600	6	0.16
65 x 40 - 200	8.82	64.9	0.354	550.7	362.3	12,400	3600	6	0.20
80 x 50 - 200	8.82	71.8	0.394	550.7	362.3	12,400	3600	6	0.35
100 x 65 - 200	13.23	112.8	0.394	405.8	268.1	14,900	3600	6	0.55
125 x 80 - 200	14.33	126.4	0.453	379.7	253.6	13,900	3000	6	0.59
125 x 100 - 200	14.11	123.0	0.512	434.8	289.9	14,400	3000	6	0.67
65 x 40 - 250	13.23	143.5	0.394	478.3	318.8	14,900	3600	5	0.20
80 x 50 - 250	13.23	143.5	0.394	405.8	275.4	14,900	3600	6	0.24
100 x 65 - 250	15.43	177.7	0.433	376.8	246.4	13,600	3000	6	0.35
125 x 80 - 250	17.64	208.4	0.492	379.7	253.6	12,600	3000	6	0.59
125 x 100 - 250	20.94	263.1	0.472	347.8	231.9	14,450	3000	6	0.91
150 x 125 - 250	22.05	300.7	0.551	358.0	239.1	13,970	2600	6	1.30
65 x 40 - 315	22.27	437.4	0.433	405.8	275.4	12,600	3000	5	0.20
80 x 50 - 315	20.28	382.7	0.472	478.3	318.8	11,800	3000	5	0.28
100 x 65 - 315	27.12	475.0	0.512	391.3	260.9	12,820	3000	6	0.37
125 x 80 - 315	28.66	519.4	0.551	379.7	253.6	12,300	3000	6	0.45
125 x 100 - 315	29.10	536.5	0.630	444.9	297.1	12,250	2800	6	0.57
150 x 125 - 315	29.54	560.4	0.630	358.0	239.1	12,160	2300	6	1.02
200 x 150 - 315	44.09	973.8	0.669	347.8	231.9	8660	1800	6	0.91
250 x 200 - 315	52.91	1230.1	0.709	347.8	231.9	7480	1800	6	1.14
125 x 80 - 400	45.19	1442.0	0.591	347.8	231.9	9990	2300	5	0.37
125 x 100 - 400	43.87	1329.2	0.630	347.8	231.9	10,140	2100	6	0.47
150 x 125 - 400	45.42	1459.1	0.669	347.8	231.9	9970	2000	6	0.71
200 x 150 - 400	66.14	2405.6	0.787	347.8	231.9	7380	1800	6	1.22
125 x 100 - 500	85.98	4213.2	0.787	347.8	231.9	6710	1600	9	0.83
150 x 125 - 500	90.39	4756.5	0.827	347.8	231.9	6510	1600	7	0.79
200 x 150 - 500	92.59	5282.7	0.866	347.8	231.9	6360	1600	6	0.85

* Higher speeds are achievable for these models using ISO-PRO Pumps (ISO5199 Standard).

Maximum working pressure will also be impacted by the pressure rating of the companion flanges and the mechanical seal.

SYMBOL	MATERIAL	SPECIFICATIONS	COMPONENT WHERE USED
CI	Cast Iron	AS1830/T260 Equivalent Standards: BS 1452 (1977) Grade 260 ANSI. 625.1 Class 40 ASTM A48 Class 40	Bell Housing Volute Casing Backplate Impeller
ZF		AS 1565/ C90250 Equivalent Standards: BS 1400 PB3, ISO 1338 CU SN 10	Volute Casing Backplate Impeller Wear rings
SS	Cast Stainless Steel	AS2074/H6B Equivalent Standards BS 100 (1976) Grade 316C16 ASTM A296 Grade CF8M	Volute Casing Backplate Impeller Wear rings
	Wrought Stainless Steel	AS 2837/316 Equivalent Standards: BS 970 Grade 319S16 ASTM A240/S31609	Impeller Washer Impeller Nut Casing & Discharge Flange Plugs
	316 Stainless Steel	AS 2548 Gr. A4-80	Bolts & Setscrews (ZF & SS Only)
	2205 Duplex Stainless Steel	UNS S31803 ASTM A276-98b	Impeller key
SGL	S.G. Iron	AS1831/ 400 - 12	Motor Shaft Clamp Volute Casing Backplate Impeller
HT	High Tensile Steel	AS 1110 Gr. 8.8	All Bolts and Setscrews
	Mild Steel Zinc Plated		Casing and Discharge Flange Plugs
	Key Steel		Impeller key

PAINTING

One Coat - Wattyl Super Etch Grey Primer (Wattyl Part No. 123907)

Two Coats - Wattyl Hammer Finish Green (Wattyl Part no. 151741)

Colour - Hammer Finish Green

SHAFT GROUP ASSEMBLY

STARLINE

MOTORPUMPS
TECHNICAL DATA

Southern Cross

CENTRIFUGAL PUMP TECHNICAL DATA

No. 1 SHAFT GROUP ASSEMBLY

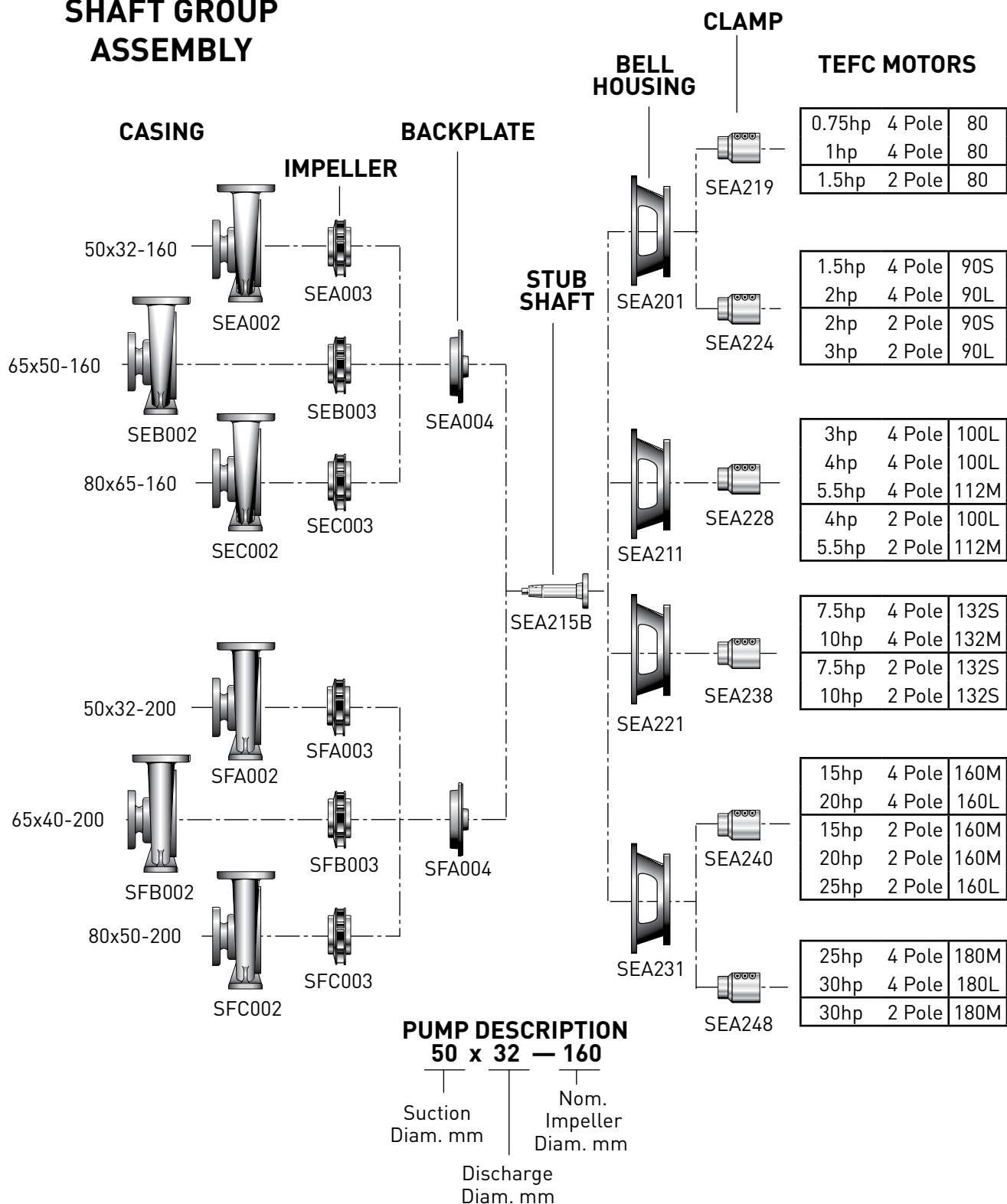

No. 2

SHAFT GROUP ASSEMBLY

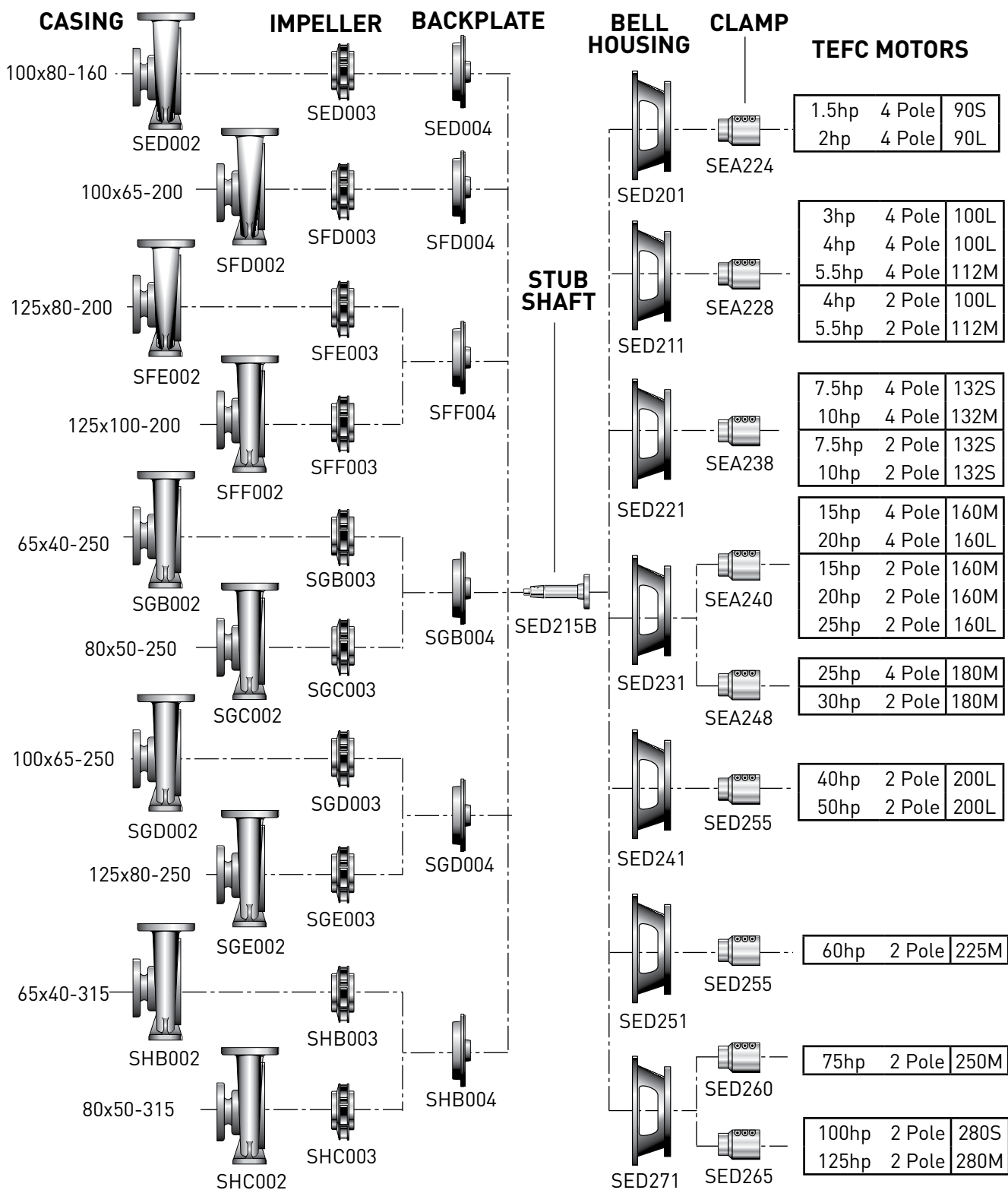

SHAFT GROUP ASSEMBLY

STARLINE
MOTORPUMPS
TECHNICAL DATA



CENTRIFUGAL PUMP TECHNICAL DATA

No. 3 SHAFT GROUP ASSEMBLY

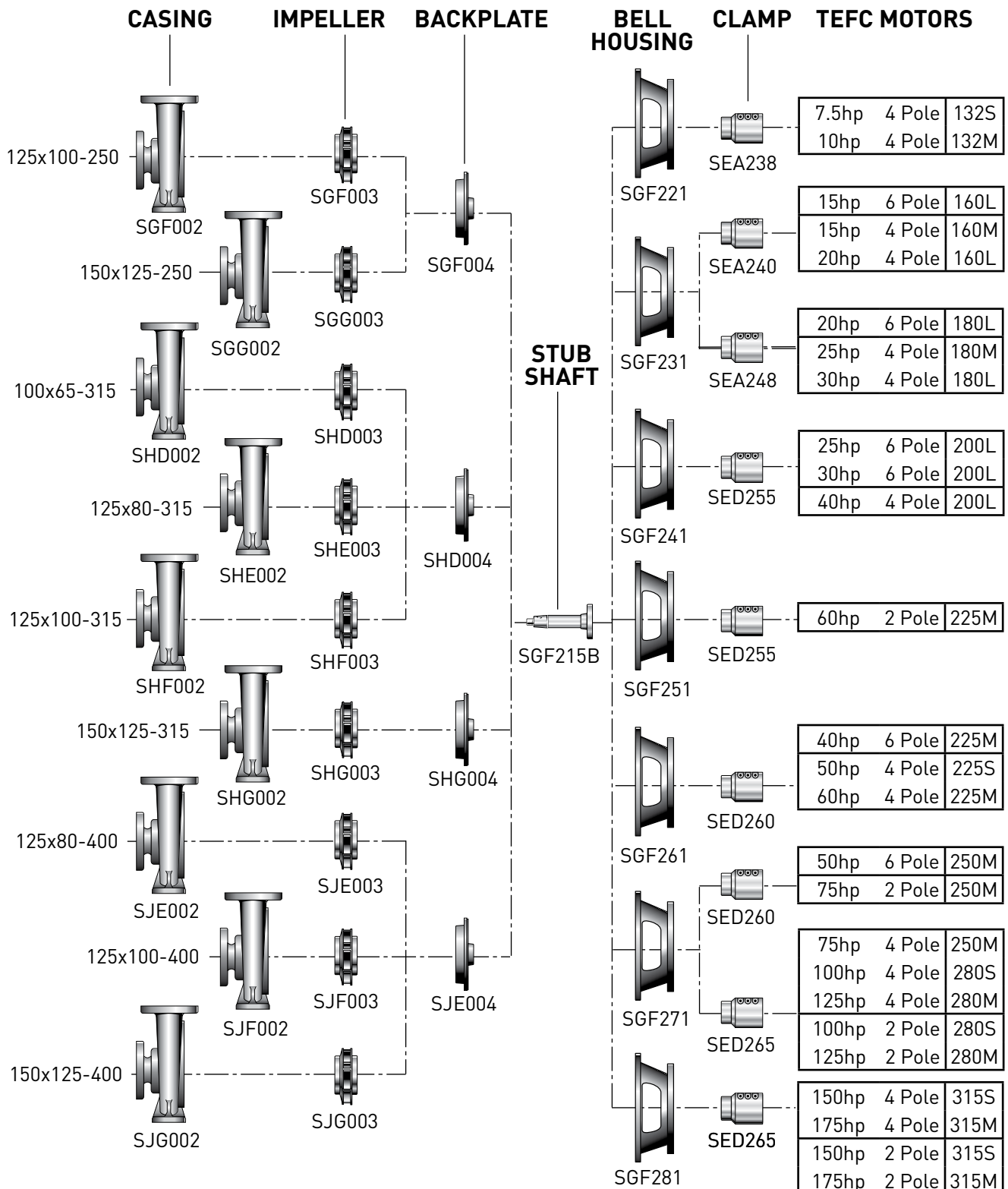

No. 4
**SHAFT GROUP
ASSEMBLY**

